

Do not scale unless scale bar reads true
 All dimensions to be confirmed on site
 Raise discrepancies before construction
 Information contained within this drawing is the sole copyright of Mango Architecture and is not to be reproduced without express permission

Revisions/Notes:
 Rev A: Toilet Layout revised
 Rev B: Bar lengthened, room divider screen added

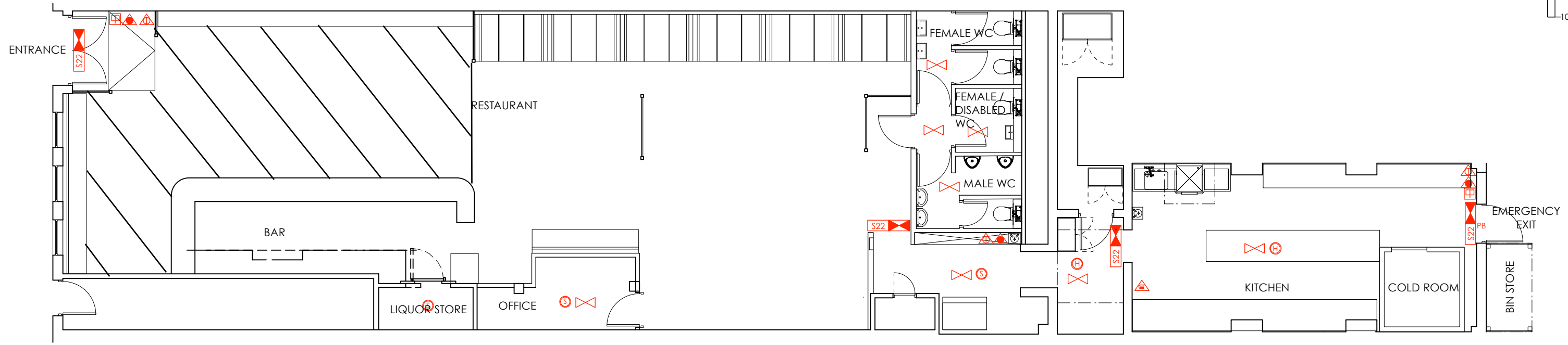

KEY TO FIRE SYMBOLS

- | | | | |
|--|--|--|---|
| | Heat Detector | | Non-maintained Emergency Lighting |
| | Heat Detector with Integral Alarm Sounder | | Maintained Emergency Lighting |
| | Optical Smoke Detector | | Non-maintained Exit Sign |
| | Optical Smoke Detector with Sounder | | Maintained Exit Sign |
| | Electronic Fire Alarm Sounder | | Non-illuminated Exit Sign |
| | Electronic Fire Alarm Sounder with Beacon | | Foam Fire Extinguisher |
| | Fire Alarm Bell | | Water Fire Extinguisher |
| | Fire Alarm Strobe | | Fire Blanket |
| | Fire Alarm Call Point With Fire Action Sign Adjacent | | Self Closing Fire Door (with Smoke Seals) |
| | Fire Alarm Panel | | Push Bars Fitted |
| | | | Free From Fastenings |
| | | | Vision Panel |

ELECTRICAL INSTALLATION & FIRE SAFETY:
 Electrical Installation to conform to BS7671
 Exit signs to conform to BS5499-1
 Fire alarm system to conform to BS 5839-1
 Fire alarm call points to conform to BS 5839-2
 Emergency lighting to conform to BS5266-1 & 7

MECHANICAL VENTILATION:
 Fresh Air In to be 60 litres/s
 Extract to be 40 litres/s
 Mechanical Extract from Toilets to be 6 litres/s

PLUMBING:
 38mm sink wastes with 75mm deep traps,
 100mm wc soil pipe with rodding access at
 every direction change, all connected to
 existing svp's.

Location and type of Fire extinguishers to be advised by LFB Inspecting Officer, details to be added.

The location and type of any fire safety and any other safety equipment may be varied from time to time with the agreement of the fire officer or after a fire risk assessment

— Licensed Area

PROJECT: 434 Kingsland Road London E8	
DRAWING TITLE: Plan As Proposed - Licensing	
JOB NO: 128	REV: B
DWG NO: 02/001	DATE: Dec 2013
SCALE: 1:100	
<input checked="" type="checkbox"/> FOR INFORMATION	<input type="checkbox"/> FOR TENDER
62 browning road london en2 0ew t:+44 780 137 1114 e: jm@mangolondon.com	