



7.5M+
FOOTFALL PA

ARCADES SHOPPING CENTRE
ASHTON-UNDER-LYNE
Greater Manchester, OL6 6DW

PRIME SPACE AVAILABLE

Limited opportunities

NEW 5,000 SQ FT  OPEN

Tenants include:

NEW
LOOK



next



3,000 STUDENTS RELOCATING INTO ASHTON
TOWN CENTRE WITH COMPLETION IN 2018

LOCATION



The Arcades Shopping Centre is Ashton's prime retail pitch. The centre sits centrally between the busy bus, railway and metro link stations, the new combined College and Council HQ, the newly refurbished Market Place and The Ladysmith Shopping Centre.

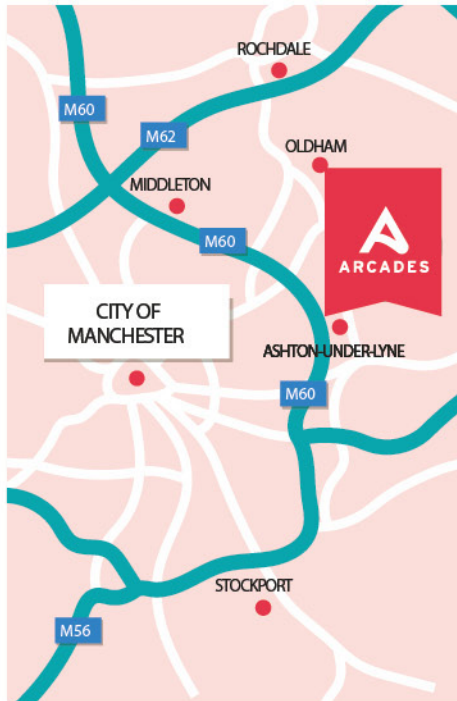

ASHTON-UNDER-LYNE IS ONE OF GREATER MANCHESTER'S STRONGEST SATELLITE TOWNS SITUATED OFF JUNCTION 23 OF THE M60



Ashton's **prime retail location**



Famous indoor and outdoor markets



Primary catchment of **193,000** (PROMIS).

Vibrant mix of national retailers





ASHTON-UNDER-LYNE RAILWAY STATION

NEW COMBINED TAMESIDE COLLEGE AND TAMESIDE COUNCIL HQ

ASHTON INDOOR MARKET HALL

A635

A6043

ASHTON OUTDOOR MARKET SQUARE



LADYSMITH SHOPPING CENTRE

ASHTON-UNDER-LYNE BUS STATION

A627

METROLINK

ALDI

IKEA

A6140



VISION



3,000 students moving into the town centre under phased relocation



EXCITING AND IMPORTANT CHANGES ARE TAKING PLACE IN ASHTON TOWN CENTRE

Tameside Metropolitan Borough Council, in partnership with Tameside College, has formed Vision Tameside.

New Advanced Skills Centre and combined Tameside Council HQ being developed immediately adjacent to the centre. Scheduled completion in 2018.

500 students already in place at the new Advanced Learning Centre (Clarendon Sixth Form College) on Camp Street.

Works are well advanced to improve the already popular market, modernising the square to attract more visitors to the town.



Immediately adjacent to The Arcades - new combined College and Tameside Council HQ under construction.

DESCRIPTION

- Weekly footfall of **145,000**
- The town's only **covered shopping centre**, totalling some **140,000 sq ft**
- Anchored by **New Look** and **Wilko**, the scheme includes a strong line up of national tenants including **Next, Foot Locker, Poundland, WH Smith** and **JD Sports**
- The town's only shopping centre with a car park offering **500 spaces with direct access to the centre**



next PEP & CO NEW LOOK

WHSmith

Superdrug



AVAILABILITY: A

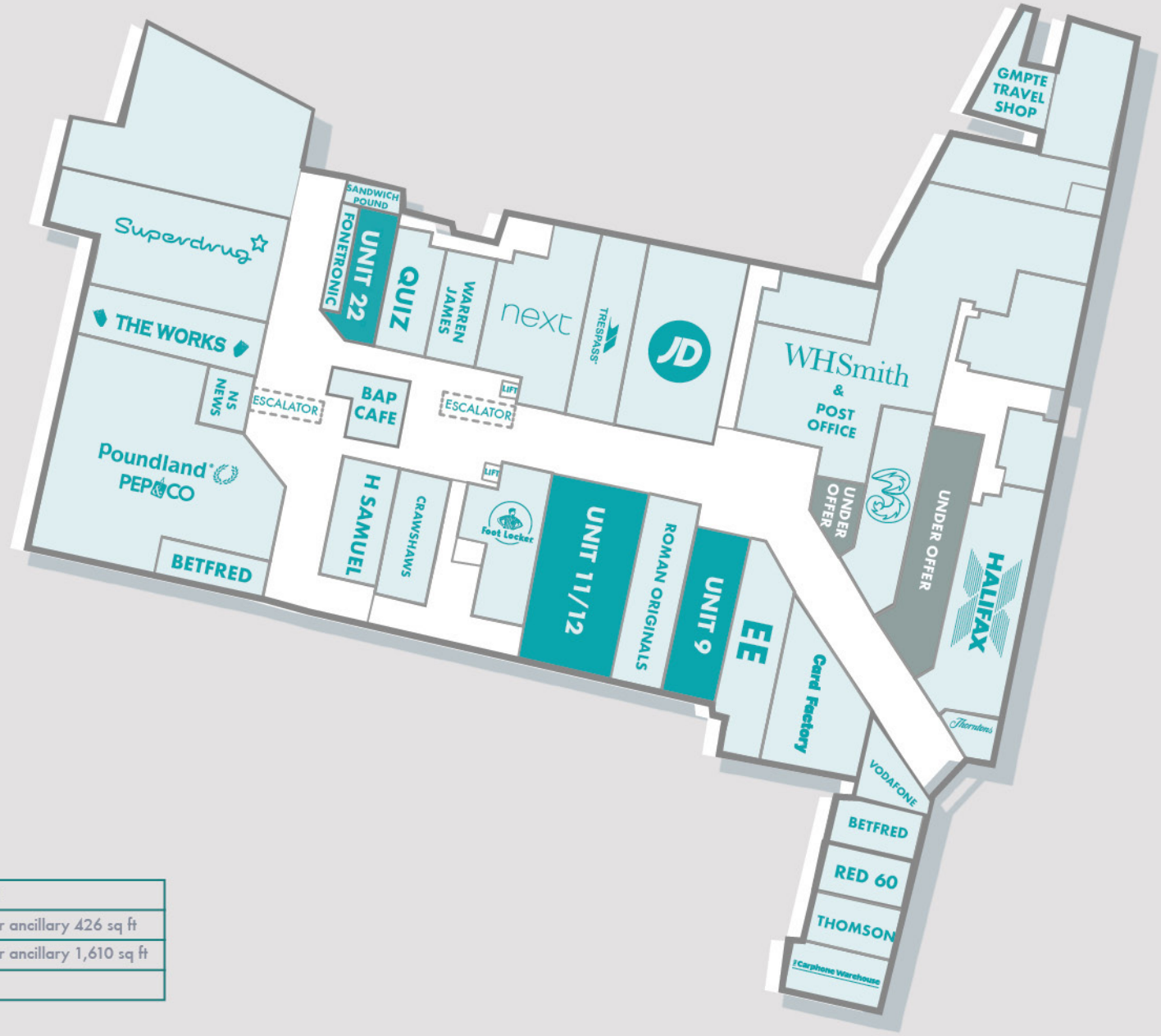

GROUND FLOOR

LET

AVAILABLE

Approximate Areas:

UNIT 9	1,569 sq ft	plus first floor ancillary 426 sq ft
UNIT 11/12	4,018 sq ft	plus first floor ancillary 1,610 sq ft
UNIT 22	1,134 sq ft	

AVAILABILITY: A

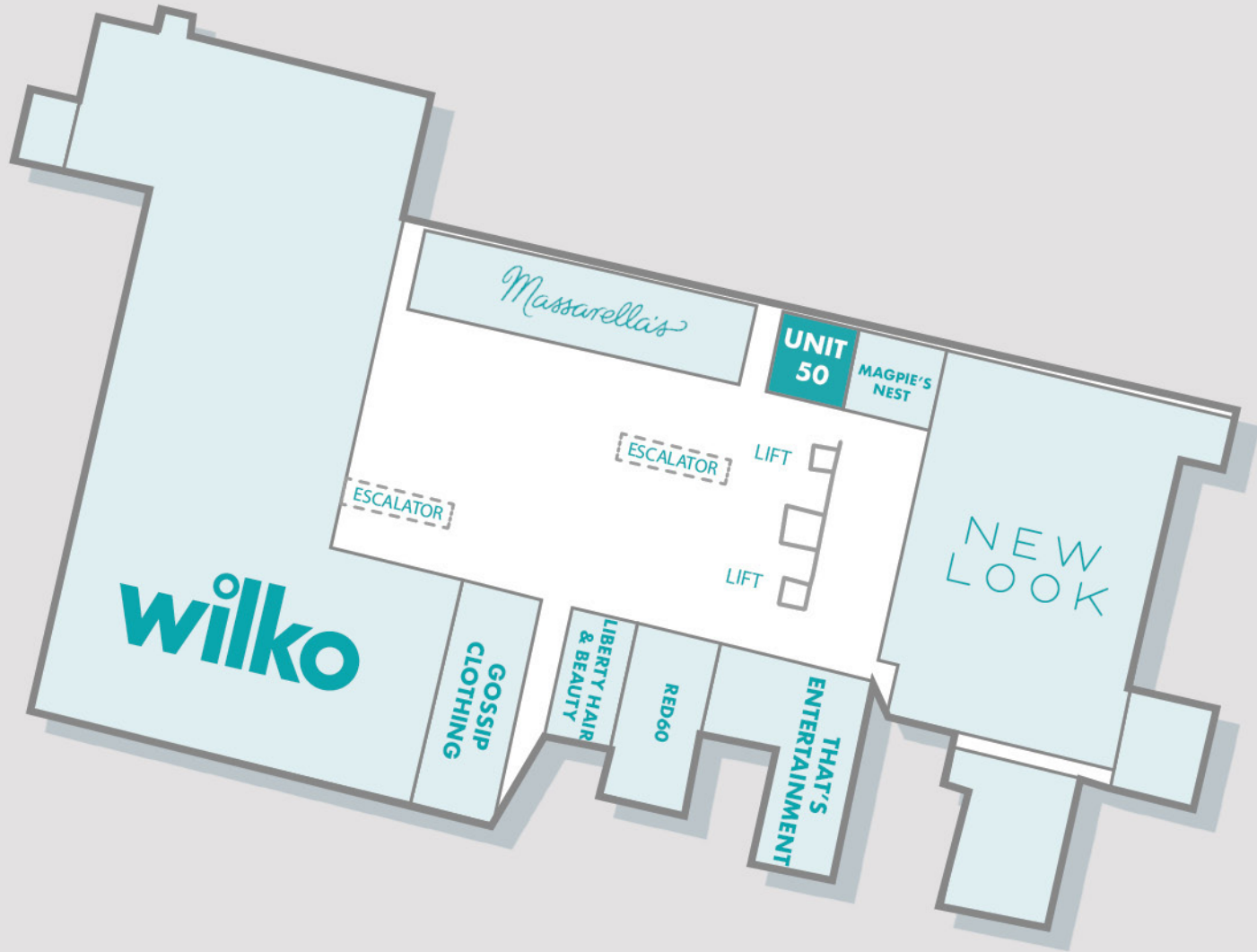

FIRST FLOOR

LET

AVAILABLE

Approximate Areas:	
UNIT 50	467 sq ft





NEW TRANSPORT INTERCHANGE

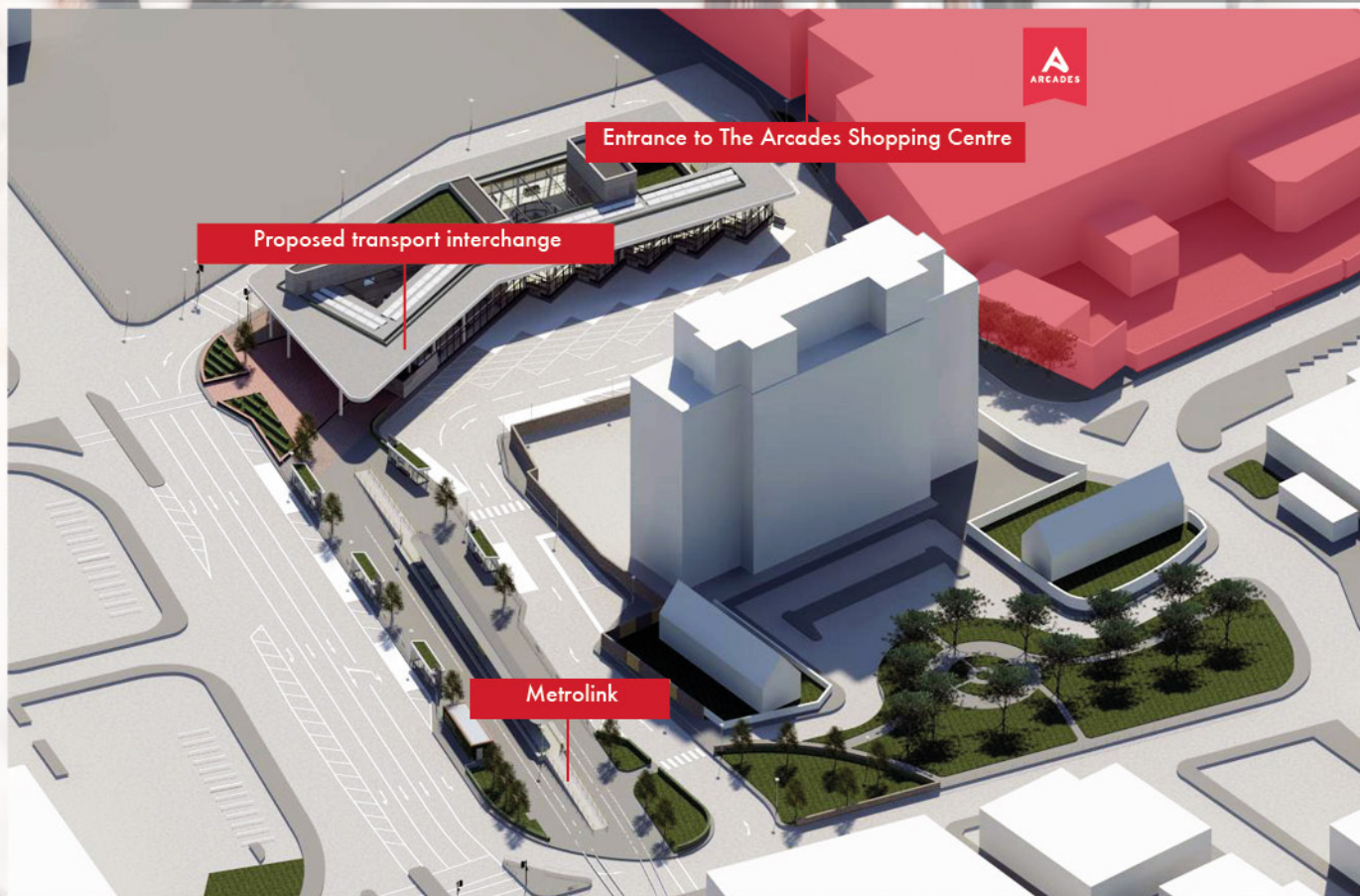

Ashton's bus station is to be redeveloped into a new state of the art facility, integrating more closely with the Metrolink station. The new bus station will be located close to the northern entrance to the Arcades Shopping Centre, providing easy customer flow and is scheduled for completion in 2019.





CONTACT

**VIEWING APPOINTMENTS
SHOULD BE MADE STRICTLY
BY PRIOR APPOINTMENT**

FOR DETAILS OF AVAILABLE UNITS CONTACT:

richard
lucas
property consultants
0161 241 7998
www.richardlucas.co.uk

Richard Lucas

Richard Lucas Property Consultants Ltd

Email richard@richardlucas.co.uk

Phone 0161 241 7998

 **barkerproudlove**
retail property consultants
0161 631 2852
www.barkerproudlove.co.uk

Richard Barker

Email richard@barkerproudlove.co.uk

Phone 0113 388 4856

Tom Prescott

Email tom@barkerproudlove.co.uk

Phone 0161 631 2854

Barker Proudlove Limited for themselves, for Richard Lucas Property Consultants Ltd, and for the vendors or lessors of this property whose agents they are given notice that: (i) the particulars are set out as a general outline only for the guidance of intending purchasers or lessees and do not constitute, nor constitute part of, an offer or contract; (ii) all descriptions, dimensions, references to condition and necessary permissions for use and occupation, and other details, are given in good faith and are believed to be correct, but any intending purchasers or tenants should not rely on them as statements or representations of fact, but satisfy themselves by inspection or otherwise as to the correctness of each of them; (iii) no person in the employment of Messrs. Barker Proudlove Limited or Richard Lucas Property Consultants Ltd has authority to make or give any representations or warranty whatever in relation to this property; (iv) all rentals and prices are quoted exclusive of VAT. March 2018.