

**SKYE
PROPERTY
CENTRE**



**HOUSE SITE, VIEWFIELD ROAD,
PORTREE, ISLE OF SKYE, IV51 9ES**



Offers: Over £100,000 are invited



- **Central Location**
- **Generous Site Extending to 0.4 Acre or Thereby**
 - **Planning Permission in Principle**
 - **Mains Services Close By**
- **Views to Loch Portree, Ben Tianavaig & Raasay**

Plot:

A rare opportunity to purchase a generous house site set in a mature garden, surrounded by trees, located in the much sought after Viewfield Road and just a short distance from the centre of Portree.

The site extends to 0.4 acre or thereby (to be confirmed by Title Deed) and benefits from Planning Permission in Principle, granted under planning reference number 23/00905/PIP, on 19 May 2023 for a single or 1½ storey property. Details are available on request or via the Planning Portal - www.highland.gov.uk/wam - using the planning reference number.

The site has views over Loch Portree towards Ben Tianavaig and Raasay.

Access to the site will be taken from an existing access which serves two other properties.

Services:

Although the services of electricity, water and mains drainage are believed to be in the vicinity, it will be for purchasers to satisfy themselves with regard to the availability of these services and arrange for connections to the same.

Location:

Viewfield Road is the main road into Portree from the south.

Portree is formed around a natural harbour and is a great attraction for visitors all year round. The town is the main administrative centre on the island and offers a wide range of facilities including primary and secondary education, doctors and dentists' surgeries, a variety of shops, banks, hotels & restaurants and sports facilities, there is also a small cinema/theatre located just a short walk away.

Viewings:

Strictly by appointment through this agency.

Directions:

As you enter Portree on the A87 from the south follow this road until you pass the petrol station. The access to the plot will be on your left with a sign for Skye Haven Bed & Breakfast at the bottom of the drive. The site will be on your left.

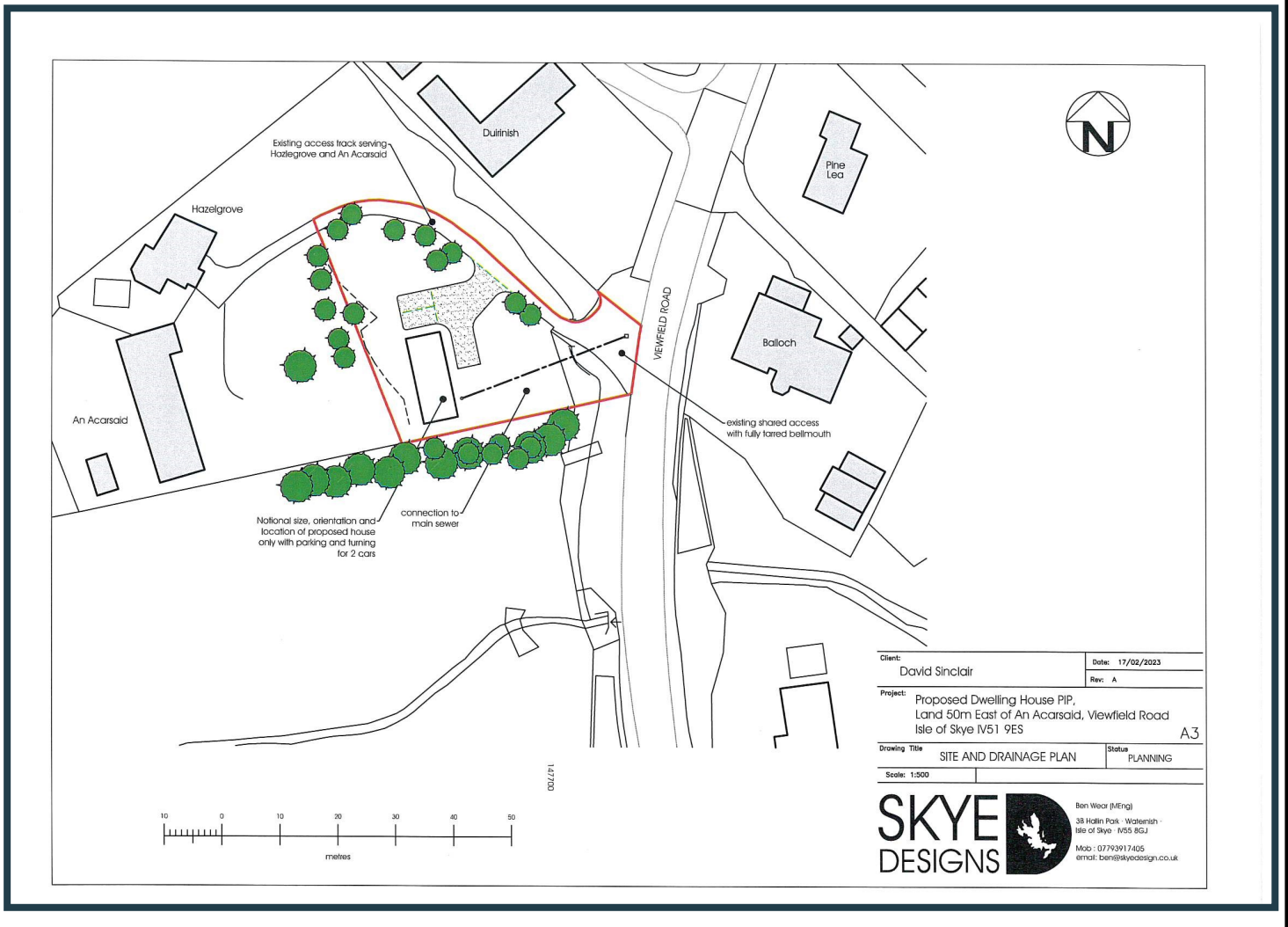



**All offers should be submitted in correct Scottish legal terms to:
Skye Property Centre, MacDonald House, Somerled Square, Portree, Isle of Skye, IV51 9EH.**

Telephone: 01478 611600 Fax 01478 61245 E-mail: enquiries@skyepropertycentre.co.uk Website: www.skyepropertycentre.co.uk

These particulars are believed to be correct but no guarantee of their accuracy is given and no error or misdescription herein shall annul any sale or be made subject of compensation by either side. Neither shall these details be deemed to form any part of any contract. Prospective purchasers are advised to take legal advice on the extent and nature of the subjects they propose to acquire.

Skye Property Centre is a trading name of Anderson MacArthur Limited, a company registered in Scotland. Company Registration Number: SC410939.
Registered Office: Old Bank of Scotland Buildings, Stornoway, Isle of Lewis, HS1 2BG.