

# Rent!

## Prominent Corner Retail Unit in Melton Mowbray Town Centre

Ground Floor Sales:  
156 sq m (1,679 sq ft)

- Ground floor sales 156 sq m (1,679 sq ft) plus first floor storage / ancillary of 227 sq m (2,443 sq ft)
- Rear service loading
- Prime High Street location
- Nearby retailers include Specsavers, Allied Pharmacy, Lounges café bar and CEX

**£25,000 Per Annum**



## Location

Melton Mowbray is a popular market town located approximately 17 miles southeast of Nottingham city centre and approximately 13 miles northeast of Leicester city centre.

The town is well established in terms of national, regional and independent retailers / occupiers.

The property is situated in a popular location with its main frontage to the town's main retail pitch.

## The Property

The property comprises a prominently fronted ground floor retail unit, which is predominantly open plan in nature.

The rear of the property provides rear service access, staff office and goods lift.

The first floor provides further stores / ancillary.

## Accommodation

	SQ M	SQ FT
Ground Floor Sales:	156	1,679
Ground floor store / loading bay:	20	215
First Floor Storage / Ancillary	207	2,228
<b>TOTAL:</b>	<b>383</b>	<b>4,122</b>

## Terms

The property is available to rent on a new full repairing and insuring lease for a term of years to be agreed.

## Business Rates

The property has the following rateable value:-

**£31,000**

*Note – this is not the amount you will pay. The actual rates payable can be calculated by using the link below:*

<https://www.gov.uk/calculate-your-business-rates>

## Planning

The property has planning for:-

**E: (Commercial Business & Service)**

*The property is suitable for alternative uses, subject to any potential occupier obtaining the necessary planning consent.*

## VAT

VAT is applicable to the rent.

## EPC

D-80

## Rent

**£25,000 Per Annum**



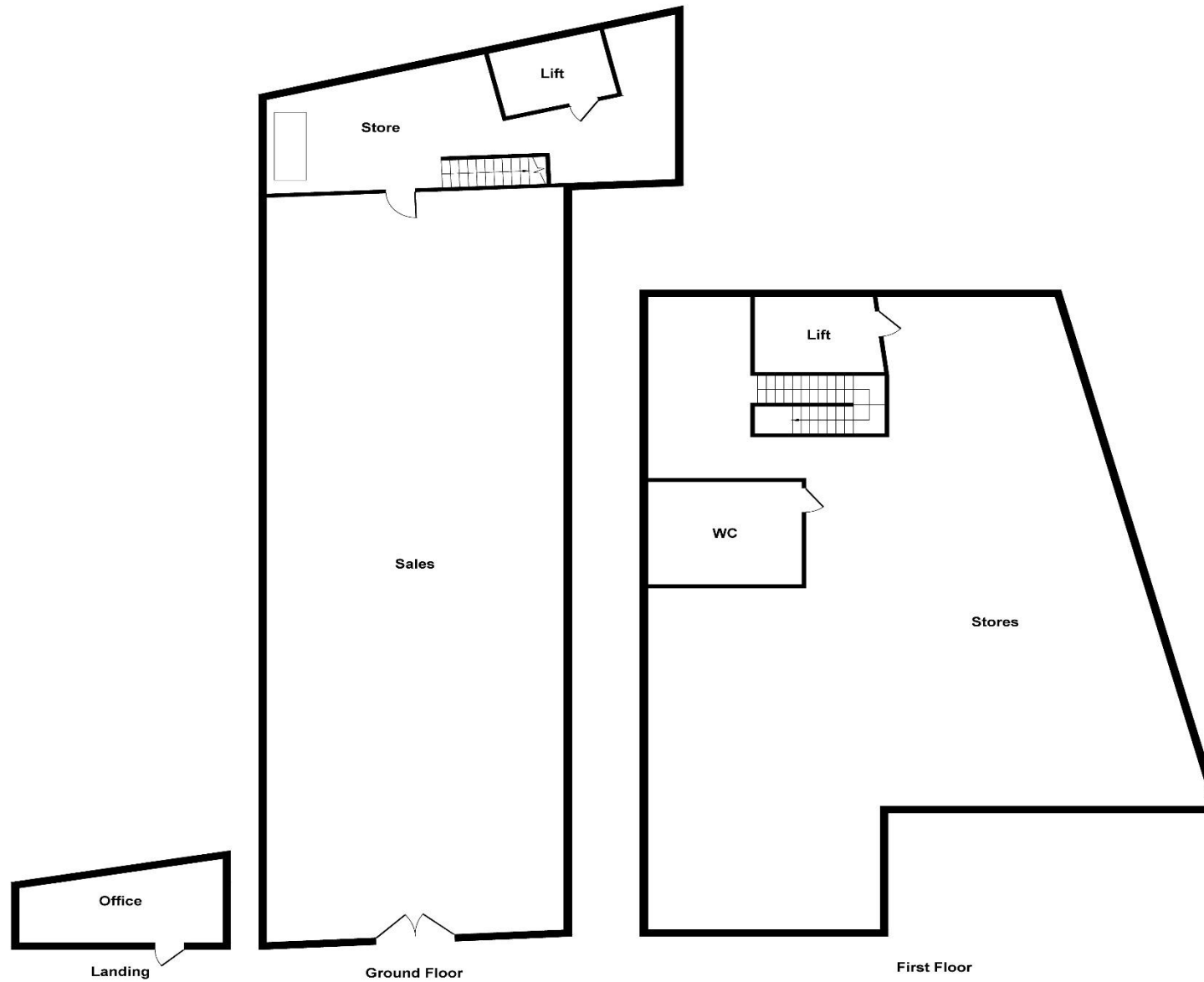

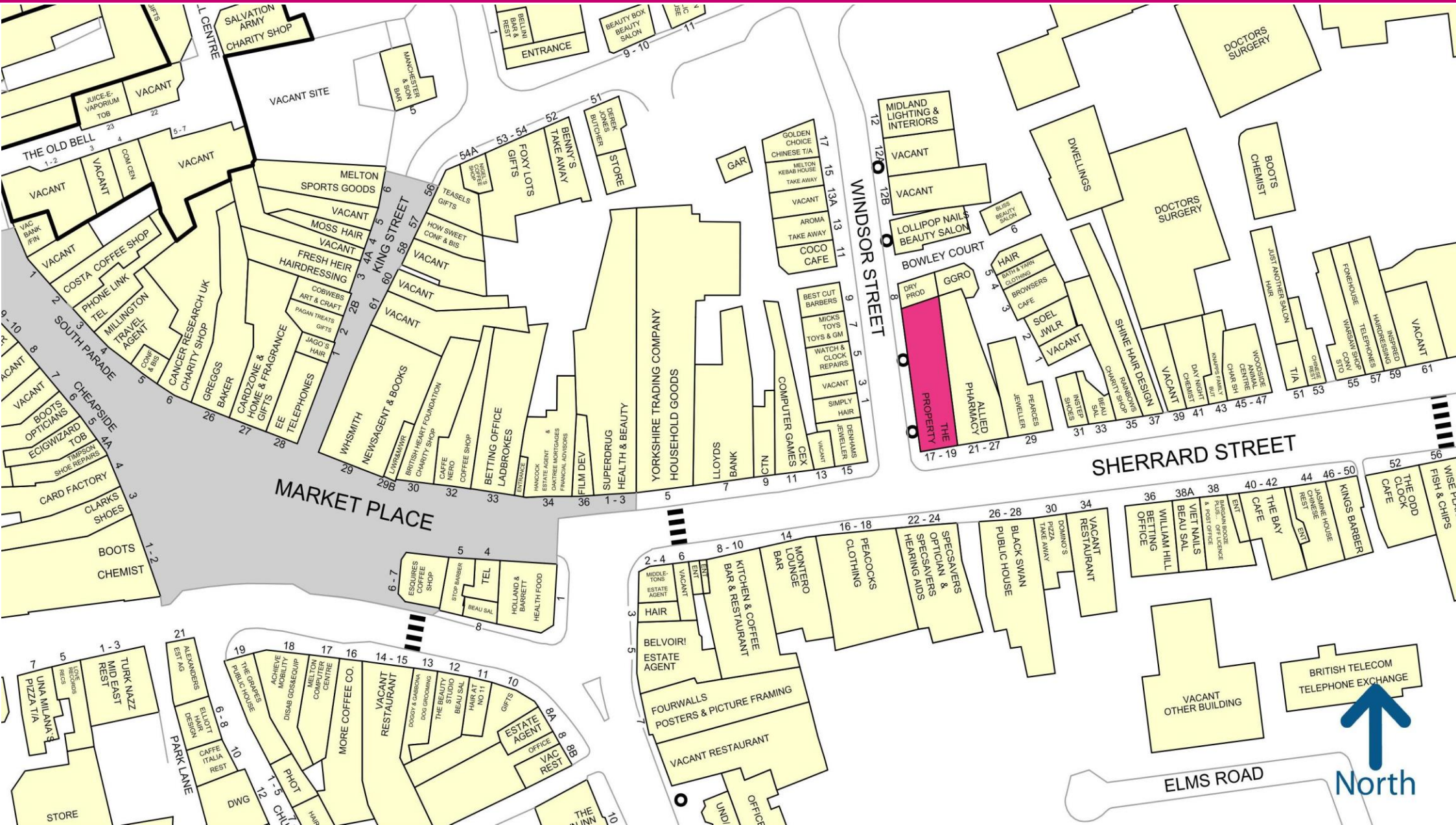

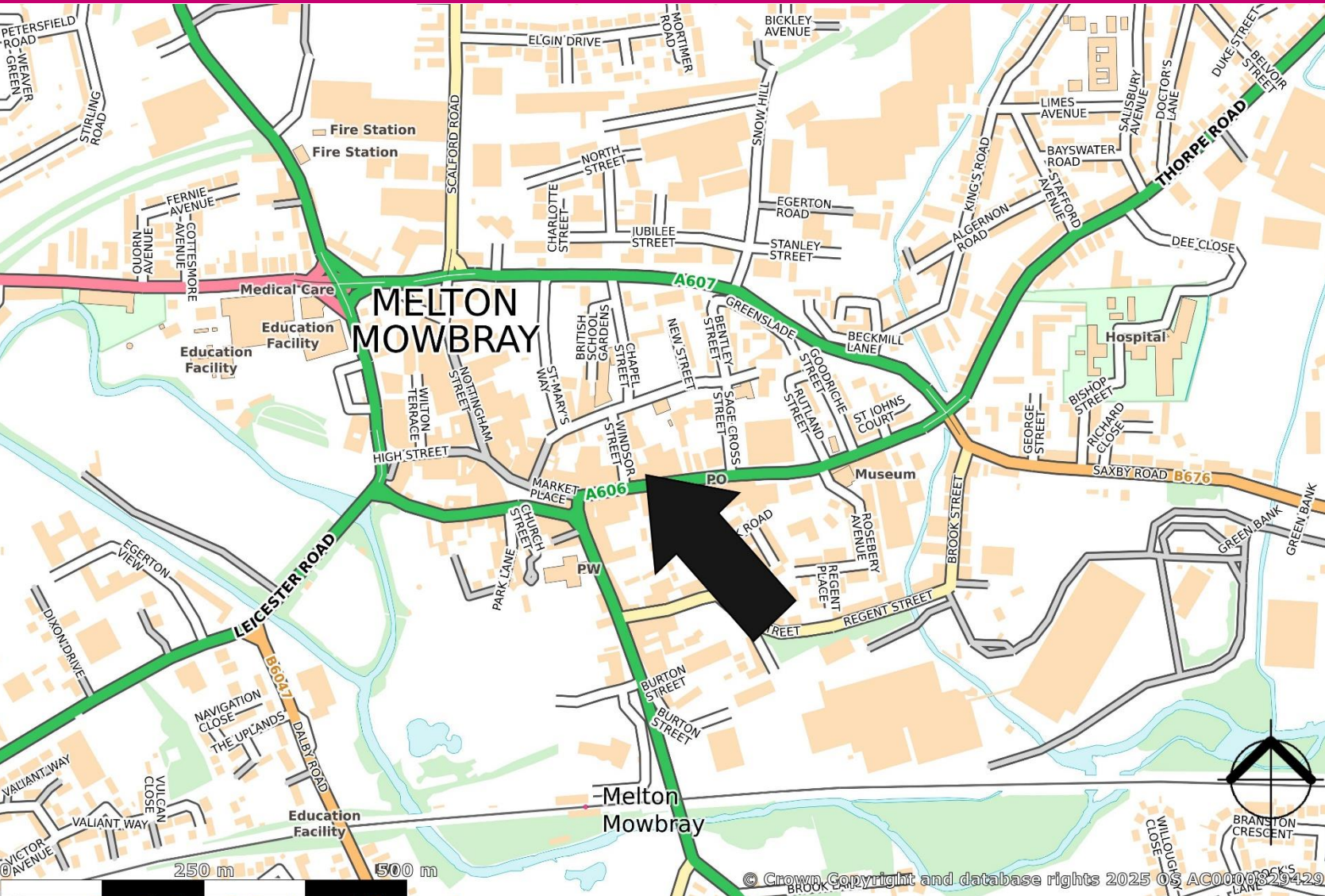

For further information or  
to arrange a viewing  
please contact:-

**Nick Witek-Morgan**  
07384 896 501  
nmorgan@heb.co.uk

**Matthew Hilton**  
07971 910 268  
mhilton@heb.co.uk



**heb Chartered Surveyors**

Canalside House, 6 Canal Street  
Nottingham NG1 7EH

0115 950 6611 | info@heb.co.uk

[heb.co.uk](http://heb.co.uk)

Misrepresentation Act:  
These particulars do not constitute part of an offer or contract. All descriptions, dimensions, reference to condition and necessary permission for use and occupation and other details contained herein are for general guidance only and prospective purchasers or tenants should not rely on them as statements or representations of fact and must satisfy themselves as to their accuracy. Neither HEB Surveyors, nor its employees or representatives have any authority to make or give any representation or warranty or enter into any contract in relation to the property. Rents quoted in these particulars may be subject to VAT in addition. The reference to any mechanical or electrical equipment or other facilities at the property shall not constitute a representation (unless otherwise stated) as to its state or condition or that it is capable of fulfilling its intended function and prospective tenants/purchasers should satisfy themselves as to the fitness of such equipment for their requirements. Prices/rents quoted in these particulars may be subject to VAT in addition. a) These particulars were prepared from preliminary plans and specifications before the completion of the properties and are intended only as a guide. They may have been changed during construction and final finishes could vary. Prospective purchasers should not rely on this information but must get their solicitor to check the plans and specifications attached to their contract. b) We have not made any investigations into the existence or otherwise of any issues concerning pollution of land, air or water contamination and the purchaser is responsible for making his own enquiries in this regard.