

MAKING
PROPERTY
WORK
SHW.CO.UK

SHW



**FOR SALE /
TO LET**

**PROMINENT RETAIL UNIT – 2,751 SQ FT (255.57 SQ M)
UNIT A, 443A BRIGHTON ROAD, SOUTH CROYDON CR2 6EU**

LOCATION

The property is prominently located on the busy A235 Brighton Road Road in South Croydon.

The property is approximately 1.9 miles South of Croydon Town Centre and 0.8 miles North of Purley Town Centre. The A23 lies 1.1 miles to the south which connects to Junction 7 of the M25 motorway (7 miles).

Purley Oaks Station is approximately 200 metres to the south east and provides regular train services to London Bridge (22 minutes) and London Victoria (32 minutes) via East Croydon.

The property lies within the administrative area of the London Borough of Croydon.

DESCRIPTION

The property comprises a ground floor retail unit, extending to approximately 2,751 sq ft (sq m).

The unit forms part of a mixed-use development comprising 79 residential apartments.

The property is to be offered shell and core.

AMENITIES / OPPORTUNITY

- Prominent main road location
- 2,751 sq ft of ground floor space
- Offered shell and core
- Three-phase electricity
- Use Class E

PRICE

To Let: **£45,000 per annum exclusive.**

For Sale: **Offers in the region of £400,000.**

RATES

We advise parties to undertake their own enquiries with the VOA.

TENURE

A full repairing and insuring lease is available on terms to be agreed.

VAT

VAT will be chargeable on the terms quoted.

LEGAL COSTS

Each party is to be responsible for their own legal fees.

EPC

The unit has an EPC rating of A

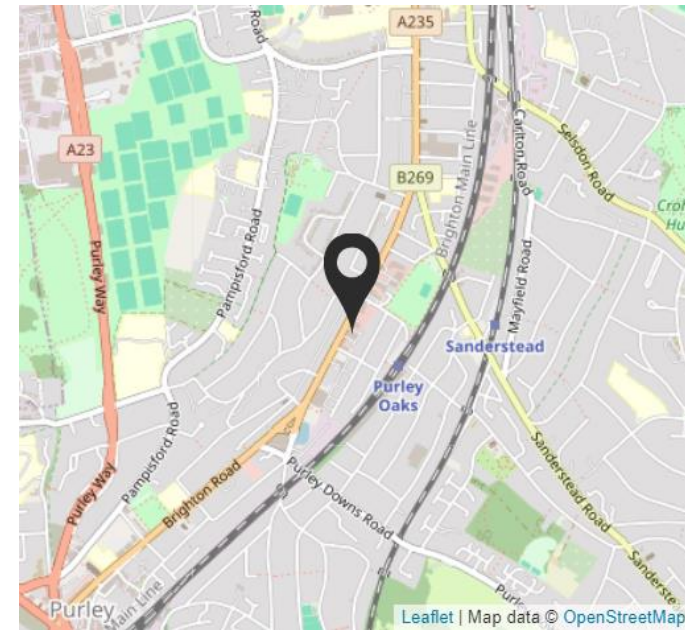

VIEWINGS

Matt Morris

t: 07894 692426

e: mmorris@shw.co.uk

Alex Thomson

t: 07780 113 019

e: athomson@shw.co.uk



@SHWProperty



SHW Property



SHW Property

**MAKING
PROPERTY
WORK**

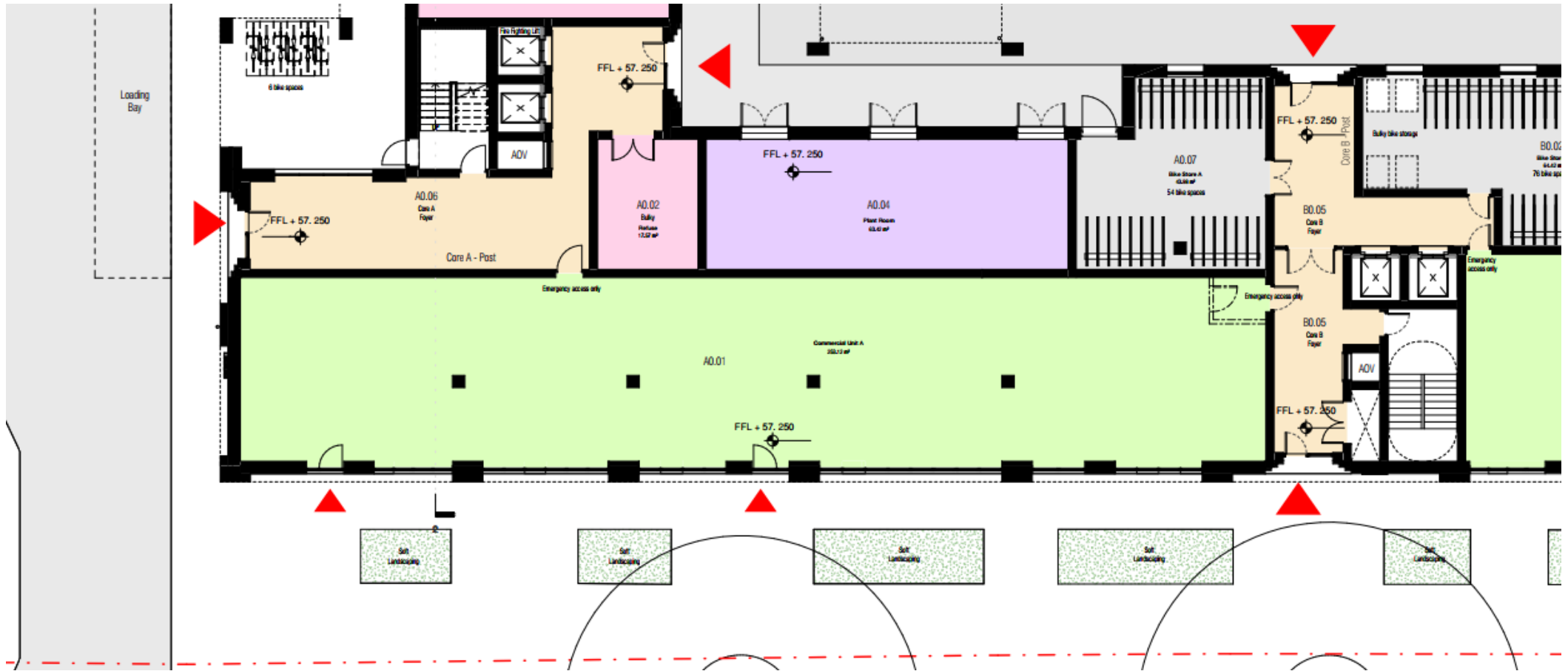

VIEWINGS

Matt Morris

t: 07894 692426

e: mmorris@shw.co.uk

Alex Thomson

t: 07780 113 019

e: athomson@shw.co.uk



@SHWProperty



SHW Property



SHW Property

**MAKING
PROPERTY
WORK**

SHW prepares sales and letting particulars diligently and all reasonable steps are taken to ensure that they are correct. Neither a seller nor a landlord nor SHW will, however, be under any liability to any purchaser or tenant or prospective purchaser or tenant in respect of them. If a property is unoccupied, SHW may not have all the information required by a prospective purchaser or tenant in its possession, may not be able to obtain it and may not be able to verify all the information which it does hold. The mention of appliances and/or services or heating/cooling system or any other plant or fenestration systems in this description does not imply that they are in working order. Prospective purchasers should make their own investigations before finalising any agreement to purchase or lease. Note: Any maps or plans included in this document are obtained from Promap or Edozo under our Ordnance Survey Business Use Copyright licence ES 100017692 or are Geo Digital Plans including mapping data licensed from Ordnance Survey Crown Copyright 2007 under licence number PU 100017316

SHW.CO.UK