

TO LET WAREHOUSE & YARD

WAREHOUSE 19,600 sq ft - 1,820 sq m

OPEN STORAGE/YARD 18,000 sq ft - 1,672 sq m



@ Gillingham Marina

173 Pier Road, Kent,

ME7 1UB



**PHOENIX
& PARTNERS**
CHARTERED SURVEYORS

Overview

Gillingham Marina occupies a total mixed site area of circa 19.56 acres / 7.91 ha

Gillingham Marina consists of:

Marina 1 Lock Basin

Marina 2 Tidal Basin

Prestige Car Showroom with car parking in front

The Waterfront Leisure Centre and Restaurant with Bar

Warehouse circa 19,600 sq ft / 1,820 sq m **TO LET**

Hard standing open storage land of circa 18,000 sq ft / 1,672 sq m **TO LET**



@ Gillingham Marina
173 Pier Road, Kent, ME7 1UB

Location

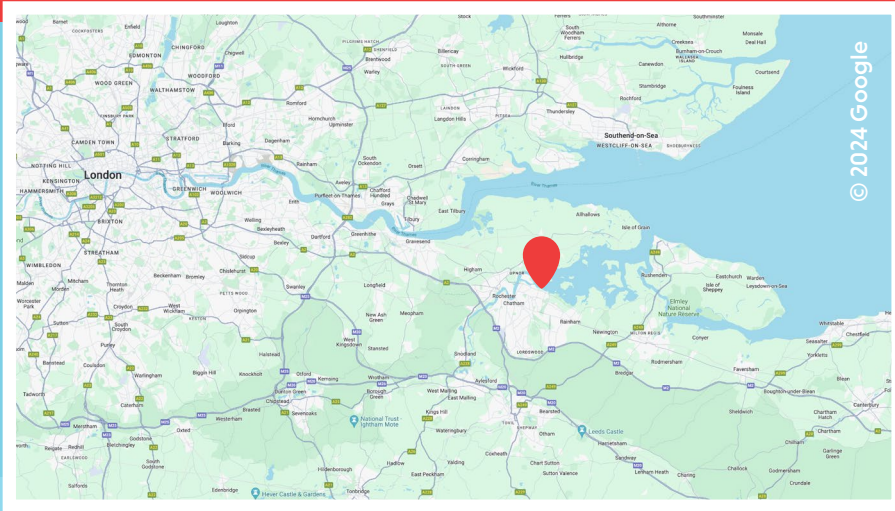

Gillingham Marina
is found at
173 Pier Road
Gillingham
Kent
ME7 1UB

The Marina is located on the south bank of the River Medway, to the north of Gillingham town centre, off the A289 Pier Road, with access to the A2 nearby. It is well placed in a location protected from winter winds.

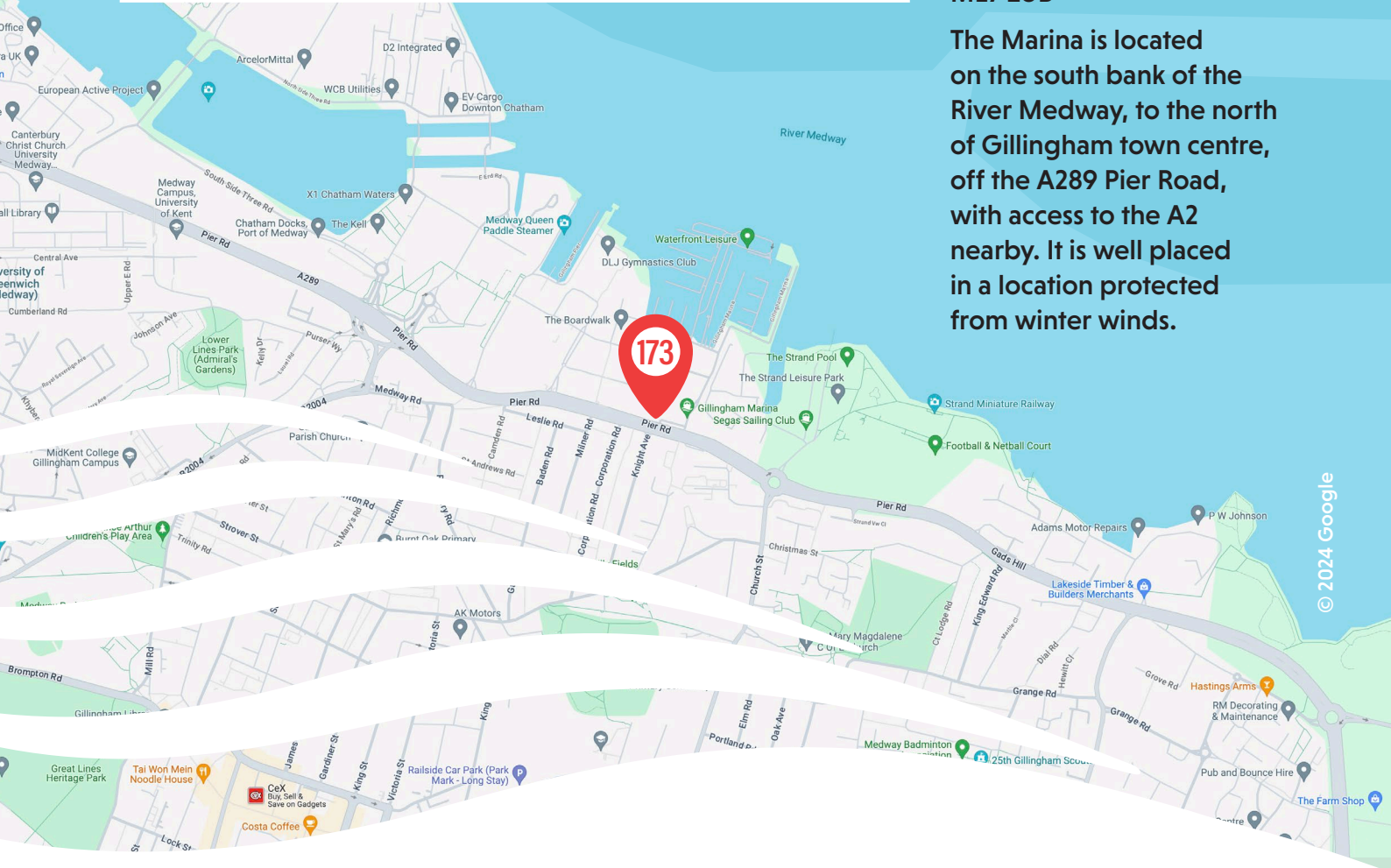

@ Gillingham Marina
173 Pier Road, Kent, ME7 1UB

The Site

Areas of this site
to be made available:

ACCOMMODATION

Warehouse:

Circa 19,600 sq ft / 1,820 sq m

Open Storage/Yard:

Circa 18,000 sq ft / 1,672 sq m

SPECIFICATION

3 phase power,
415V

9.2m eaves

2 loading shutter doors
of 9.2m high



Floor Plans

Yard Area
APPROX. AREA
18,000 sq ft - 1,672 m²

Warehouse
APPROX. GROSS
INTERNAL AREA
19,600 sq ft - 1,820 m²

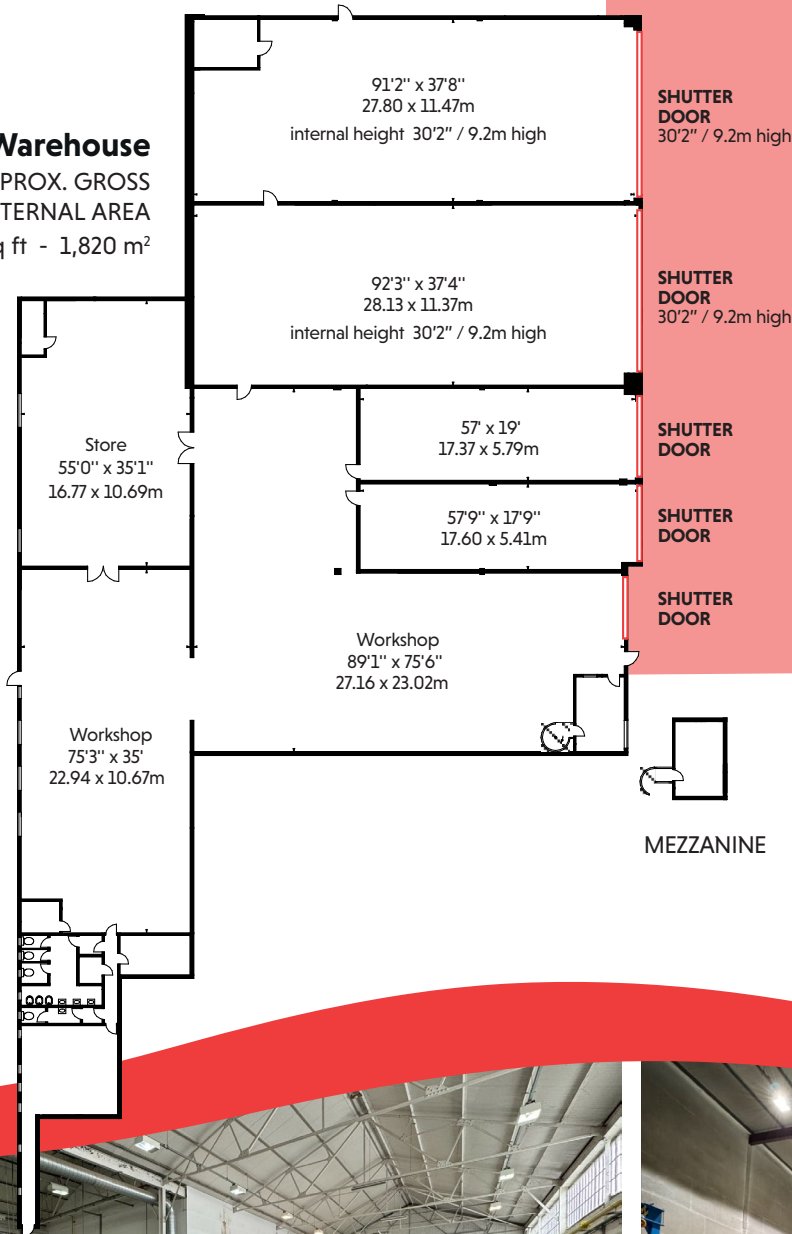

The warehouse has
3 phase power
at 415V

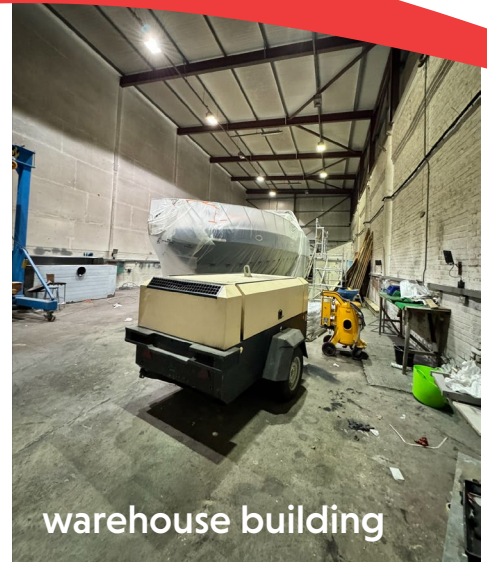

Tenure

TO LET On a new full repairing and insuring lease, rent on application
For EPC, Rateable Value or other information, all are available on request.

VIEWING By appointment with the sole agents Phoenix and Partners.

Richard Phoenix FRICS

telephone: 020 7323 4123

email: rphoenix@phoenixandpartners.co.uk

warehouse
interior



**PHOENIX
& PARTNERS**
CHARTERED SURVEYORS

72 Newman Street, London W1T 3EH
telephone: 020 7323 4123
www.phoenixandpartners.co.uk

Messrs Phoenix and Partners for themselves and for the vendors or lessors of this property whose agents they are give notice that: (i) The particulars are set out as a general outline only for the guidance of intending purchasers or lessees and do not constitute, nor constitute part of an offer or contract. (ii) All descriptions, dimensions, references to condition and necessary permissions for use and occupation and other details are given in good faith and are believed to be correct but any intending purchasers or tenants should not rely on them as statements or representations of fact but must satisfy themselves by inspection or otherwise as to the correctness of each item. (iii) No person in the employ of Messrs Phoenix and Partners has any authority to make or give any representation or warranty whatever in relation to this property.