



OFFICE TO LET

## 7-9 SWALLOW STREET

London, W1B 4DE

STUNNING NEWLY REFURBISHED CAT A+ OFFICE AVAILABLE FOR  
IMMEDIATE OCCUPATION

2,275 SQ FT (211.35 SQ M)



**BNP PARIBAS  
REAL ESTATE**

[www.realestate.bnpparibas.co.uk](http://www.realestate.bnpparibas.co.uk)

7-9 SWALLOW STREET

London, W1B

TO REQUEST A VIEWING CALL US 0207 629 7282



BNP PARIBAS  
REAL ESTATE

www.realestate.bnpparibas.co.uk

## DETAILS

### DESCRIPTION

Stunning newly refurbished CAT A+ office available for immediate occupation

### ACCOMMODATION

The accommodation comprises the following areas:

Name	sq ft	sq m	Availability
3rd - CAT A +	2,275	211.35	Available
<b>Total</b>	<b>2,275</b>	<b>211.35</b>	

### KEY FEATURES

- CAT A+
- Two meeting rooms
- Timber flooring
- Kitchenette & breakout area
- Air-conditioning
- Excellent natural light
- Private office
- Plug and play - pre installed fibre and Wi-Fi connectivity

### OUTGOINGS

- **Rent:** £120 per sq ft
- **Rates:** £32.59 per sq ft
- **Service charge:** £12.09 per sq ft
- **EPC:** B

7-9 SWALLOW STREET

London, W1B

TO REQUEST A VIEWING CALL US 0207 629 7282



**BNP PARIBAS  
REAL ESTATE**

www.realestate.bnpparibas.co.uk

## LOCATION



Ideally located in the heart of Mayfair

### CONTACT US

Alex Hunt  
020 7318 5038  
[alex.hunt@realestate.bnpparibas](mailto:alex.hunt@realestate.bnpparibas)

Katrina Love  
07818 290 253  
[Katrina.Love@realestate.bnpparibas](mailto:Katrina.Love@realestate.bnpparibas)

Michelle Njuguna  
[michele.njuguna@realestate.bnpparibas](mailto:michele.njuguna@realestate.bnpparibas)

BNP Paribas Real Estate (West End)  
24 Savile Row, London, W1S 2ES

[www.realestate.bnpparibas.co.uk](http://www.realestate.bnpparibas.co.uk)  
0207 629 7282  
[realestate.enquiries@bnpparibas.com](mailto:realestate.enquiries@bnpparibas.com)  
[linkedin.com/company/bnp-paribas-real-estate/@BNPPRE\\_UK](https://www.linkedin.com/company/bnp-paribas-real-estate/@BNPPRE_UK)

Misrepresentation Act 1967: BNP Paribas Real Estate Advisory & Property Management UK Limited for themselves and for the vendor(s) or lessor(s) of this property whose agents they are, give notice that: 1. These particulars do not constitute, nor constitute any part of, an offer or contract. 2. None of the statements contained in these particulars as to the property are to be relied on as statements or representations of fact. 3. Any intending purchaser or lessee must satisfy himself by inspection or otherwise as to the correctness of each of the statements contained in these particulars. 4. The vendor(s) or lessor(s) do not make or give and neither BNP Paribas Real Estate Advisory & Property Management UK Limited nor any person in their employment has any authority to make or give, any representation or warranty whatever in relation to this property. Finance Act 2013: Unless otherwise stated all prices and rents are quote exclusive of VAT. The Business Protection from Misleading Marketing Regulations 2008: These details are believed to be correct at the time of compilation but may be subject to subsequent amendment. Generated by Agentsinsight / Generated on 29/07/2025

7-9 SWALLOW STREET, LONDON, W1B 4DE

TO REQUEST A VIEWING CALL US ON 0207 629 7282



**BNP PARIBAS  
REAL ESTATE**

[www.realestate.bnpparibas.co.uk](http://www.realestate.bnpparibas.co.uk)

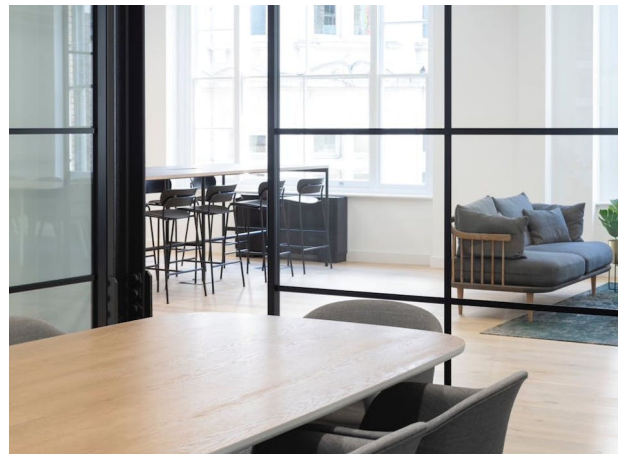

7-9 SWALLOW STREET, LONDON, W1B 4DE  
TO REQUEST A VIEWING CALL US ON 0207 629 7282



[www.realestate.bnpparibas.co.uk](http://www.realestate.bnpparibas.co.uk)



7-9 SWALLOW STREET, LONDON, W1B 4DE  
TO REQUEST A VIEWING CALL US ON 0207 629 7282



[www.realestate.bnpparibas.co.uk](http://www.realestate.bnpparibas.co.uk)



REVISION

- 01 21.08.2024  
DESKS CHANGED TO 1600MM  
WIDE
- 02 23.08.2024  
1NO 1600MM DESK ADDED TO  
END OF BENCHES

Client

STEWART WATSON

Site

7-9 Swallow Street  
London  
W1B 4DE

Title

AS PROPOSED  
SMALL POWER & DATA

Drawing No.

267\_03\_004 - 02

Date

19.08.24

Scale

1:50 @ A2

Drawn By

MG

Approved By

JL

This drawing remains the property of North Interiors and can not be used or reproduced without prior consent.

NORTH INTERIORS LTD

31 PARK FARM  
ERMINE STREET  
BUNTINGFORD  
HERTS SG9 9AZ

T 01763 272 540

INFO@NORTHINTERIORS.COM  
WWW.NORTHINTERIORS.COM

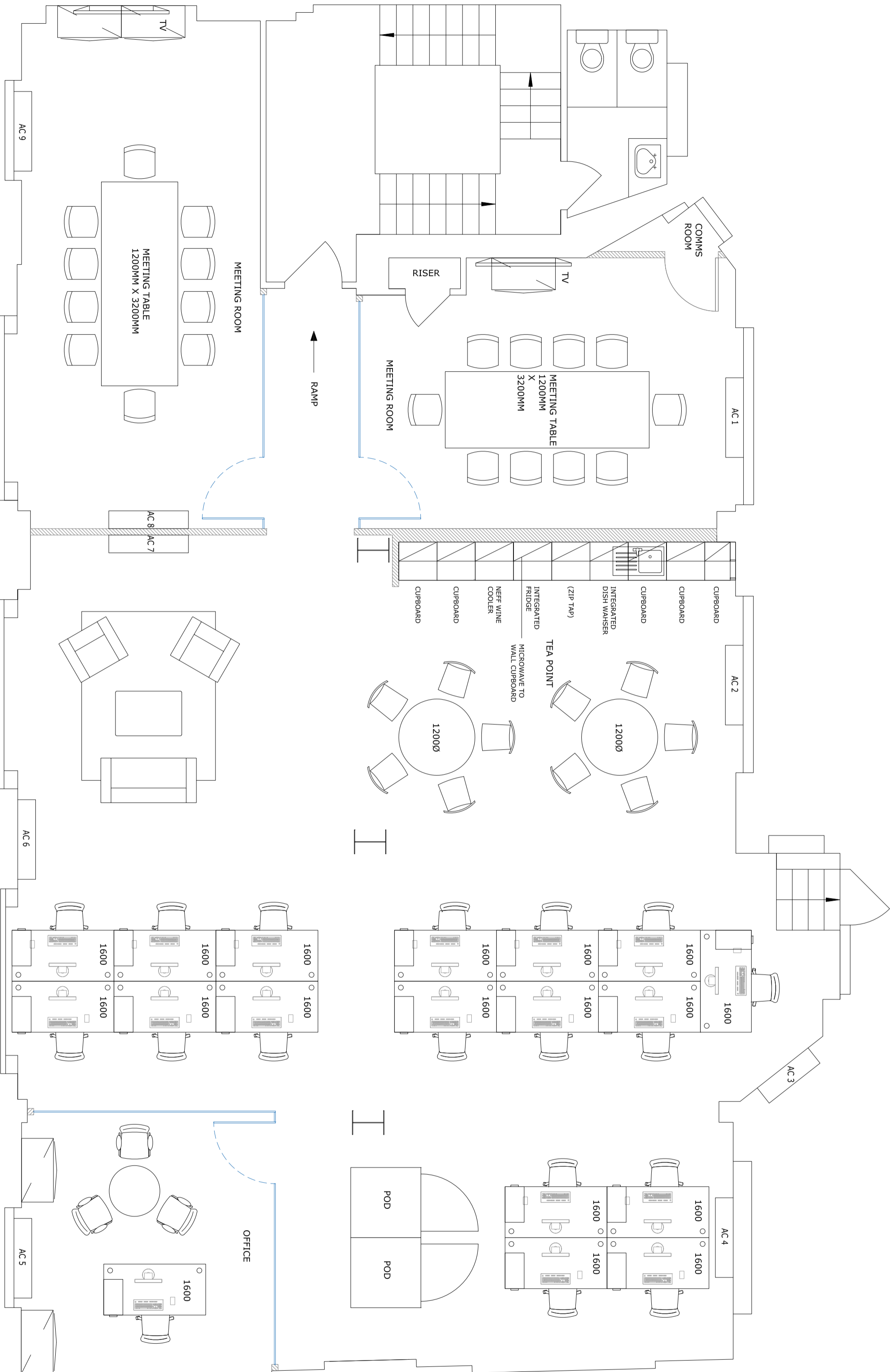

SWALLOW STREET