



PRICE LIST



## Your Space To Work

---

The Grade II listed Northlight Industries complex provides exceptional office and industrial workspace tailored to meet the diverse needs of various businesses.

It encompasses 75,000 square feet of office space, 50,000 square feet of industrial space, and 25,000 square feet designated for self-storage. We are prepared to support your business with facilities that uphold the highest standards.





## Design & Build

---

Why not design a customisable space that's perfectly in tune with your business's brand? Change the layout and configure the space design to match your team's needs. Then add a company logo and branding. And even fill the space with your choice of furniture, tech and storage options.

We can factor in the costs within the pricing, providing a cost-effective solution to personalise your office environment according to your requirements.



# FLOOR PLAN

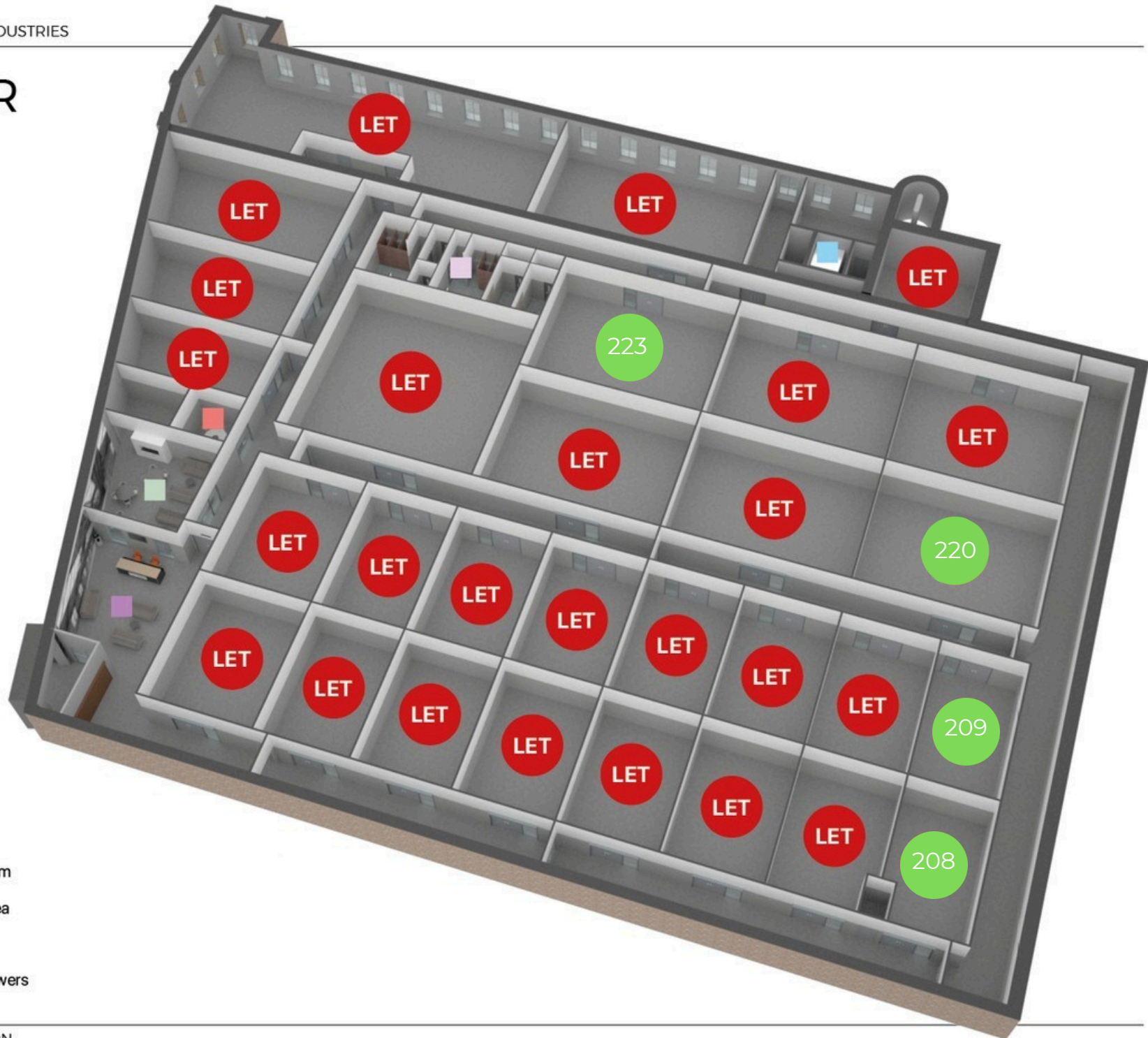

- Reception
- Meeting room
- Breakout area
- Lift area
- WC's & showers



# Price List



Unit number	Size Sq/Ft	Price per month	Service charge	Parking
Unit 201	LET	LET	LET	LET
Unit 202	LET	LET	LET	LET
Unit 203	LET	LET	LET	LET
Unit 204	LET	LET	LET	LET
Unit 205	LET	LET	LET	LET
Unit 206	LET	LET	LET	LET
Unit 207	LET	LET	LET	LET
Unit 208	650 Sq/Ft	£425.00	INCLUDED	INCLUDED
Unit 209	650 Sq/Ft	£425.00	INCLUDED	INCLUDED
Unit 210	LET	LET	LET	LET
Unit 211	LET	LET	LET	LET
Unit 212	LET	LET	LET	LET
Unit 213	LET	LET	LET	LET
Unit 214	LET	LET	LET	LET
Unit 215	LET	LET	LET	LET
Unit 216	LET	LET	LET	LET
Unit 217	LET	LET	LET	LET
Unit 218	LET	LET	LET	LET



# Price List



Unit number	Size Sq/Ft	Price per month	Service charge	Parking
Unit 219	LET	LET	LET	LET
Unit 220	1,300 sq/ft	£875	INCLUDED	INCLUDED
Unit 221	LET	LET	LET	LET
Unit 222	LET	LET	LET	LET
Unit 223	1,300 sq/ft	£875	INCLUDED	INCLUDED
Unit 224	LET	LET	LET	LET
Unit 225	LET	LET	LET	LET
Unit 226	LET	LET	LET	LET
Unit 227	LET	LET	LET	LET
Unit 228	LET	LET	LET	LET
Unit 229	LET	LET	LET	LET

**Special Offer: 50% off the first 3 months - Terms & conditions apply.**



**Contact**  
Michael Webster

**Tel:**  
01282 222 000

**Mob:**  
07377 882 563

**Web:**  
[northlightindustries.co.uk](http://northlightindustries.co.uk)

**Email:**  
[mw@northlightindustries.co.uk](mailto:mw@northlightindustries.co.uk)

**Address:**  
Northlight Industries,  
Unit 2, Northlight House  
Pendle Road  
Brierfield, Nelson  
BB9 5FL

Figures shown are for illustration purposes only. The price is based on the first 3 months' half price, after that monthly rental will increase. (VAT not included). All agreements are subject to contract. Northlight reserve the right to alter prices at any time.

