

CONSTRUCTION NOTES:
 1. REMOVE EXISTING PARTS OF EXISTING AND NEW TENANT SEPARATION WALLS AND REPAIR WORK AS SHOWN.
 2. REMOVE EXISTING PARTS OF EXISTING AND NEW TENANT SEPARATION WALLS AND REPAIR WORK AS SHOWN.
 3. REMOVE EXISTING PARTS OF EXISTING AND NEW TENANT SEPARATION WALLS AND REPAIR WORK AS SHOWN.
 4. REMOVE EXISTING PARTS OF EXISTING AND NEW TENANT SEPARATION WALLS AND REPAIR WORK AS SHOWN.
 5. REMOVE EXISTING PARTS OF EXISTING AND NEW TENANT SEPARATION WALLS AND REPAIR WORK AS SHOWN.
 6. REMOVE EXISTING PARTS OF EXISTING AND NEW TENANT SEPARATION WALLS AND REPAIR WORK AS SHOWN.
 7. REMOVE EXISTING PARTS OF EXISTING AND NEW TENANT SEPARATION WALLS AND REPAIR WORK AS SHOWN.
 8. REMOVE EXISTING PARTS OF EXISTING AND NEW TENANT SEPARATION WALLS AND REPAIR WORK AS SHOWN.
 9. REMOVE EXISTING PARTS OF EXISTING AND NEW TENANT SEPARATION WALLS AND REPAIR WORK AS SHOWN.
 10. REMOVE EXISTING PARTS OF EXISTING AND NEW TENANT SEPARATION WALLS AND REPAIR WORK AS SHOWN.

NEW ADA BATHROOM NOTES:
 1. NEW ADA BATHROOMS SHALL BE REMOVED AND REINSTALLED AS SHOWN.
 2. NEW ADA BATHROOMS SHALL BE REMOVED AND REINSTALLED AS SHOWN.
 3. NEW ADA BATHROOMS SHALL BE REMOVED AND REINSTALLED AS SHOWN.
 4. NEW ADA BATHROOMS SHALL BE REMOVED AND REINSTALLED AS SHOWN.
 5. NEW ADA BATHROOMS SHALL BE REMOVED AND REINSTALLED AS SHOWN.
 6. NEW ADA BATHROOMS SHALL BE REMOVED AND REINSTALLED AS SHOWN.
 7. NEW ADA BATHROOMS SHALL BE REMOVED AND REINSTALLED AS SHOWN.
 8. NEW ADA BATHROOMS SHALL BE REMOVED AND REINSTALLED AS SHOWN.
 9. NEW ADA BATHROOMS SHALL BE REMOVED AND REINSTALLED AS SHOWN.
 10. NEW ADA BATHROOMS SHALL BE REMOVED AND REINSTALLED AS SHOWN.

NEW ADA BATHROOM NOTES:
 1. NEW ADA BATHROOMS SHALL BE REMOVED AND REINSTALLED AS SHOWN.
 2. NEW ADA BATHROOMS SHALL BE REMOVED AND REINSTALLED AS SHOWN.
 3. NEW ADA BATHROOMS SHALL BE REMOVED AND REINSTALLED AS SHOWN.
 4. NEW ADA BATHROOMS SHALL BE REMOVED AND REINSTALLED AS SHOWN.
 5. NEW ADA BATHROOMS SHALL BE REMOVED AND REINSTALLED AS SHOWN.
 6. NEW ADA BATHROOMS SHALL BE REMOVED AND REINSTALLED AS SHOWN.
 7. NEW ADA BATHROOMS SHALL BE REMOVED AND REINSTALLED AS SHOWN.
 8. NEW ADA BATHROOMS SHALL BE REMOVED AND REINSTALLED AS SHOWN.
 9. NEW ADA BATHROOMS SHALL BE REMOVED AND REINSTALLED AS SHOWN.
 10. NEW ADA BATHROOMS SHALL BE REMOVED AND REINSTALLED AS SHOWN.

NEW ADA BATHROOM NOTES:
 1. NEW ADA BATHROOMS SHALL BE REMOVED AND REINSTALLED AS SHOWN.
 2. NEW ADA BATHROOMS SHALL BE REMOVED AND REINSTALLED AS SHOWN.
 3. NEW ADA BATHROOMS SHALL BE REMOVED AND REINSTALLED AS SHOWN.
 4. NEW ADA BATHROOMS SHALL BE REMOVED AND REINSTALLED AS SHOWN.
 5. NEW ADA BATHROOMS SHALL BE REMOVED AND REINSTALLED AS SHOWN.
 6. NEW ADA BATHROOMS SHALL BE REMOVED AND REINSTALLED AS SHOWN.
 7. NEW ADA BATHROOMS SHALL BE REMOVED AND REINSTALLED AS SHOWN.
 8. NEW ADA BATHROOMS SHALL BE REMOVED AND REINSTALLED AS SHOWN.
 9. NEW ADA BATHROOMS SHALL BE REMOVED AND REINSTALLED AS SHOWN.
 10. NEW ADA BATHROOMS SHALL BE REMOVED AND REINSTALLED AS SHOWN.

NEW ADA BATHROOM NOTES:
 1. NEW ADA BATHROOMS SHALL BE REMOVED AND REINSTALLED AS SHOWN.
 2. NEW ADA BATHROOMS SHALL BE REMOVED AND REINSTALLED AS SHOWN.
 3. NEW ADA BATHROOMS SHALL BE REMOVED AND REINSTALLED AS SHOWN.
 4. NEW ADA BATHROOMS SHALL BE REMOVED AND REINSTALLED AS SHOWN.
 5. NEW ADA BATHROOMS SHALL BE REMOVED AND REINSTALLED AS SHOWN.
 6. NEW ADA BATHROOMS SHALL BE REMOVED AND REINSTALLED AS SHOWN.
 7. NEW ADA BATHROOMS SHALL BE REMOVED AND REINSTALLED AS SHOWN.
 8. NEW ADA BATHROOMS SHALL BE REMOVED AND REINSTALLED AS SHOWN.
 9. NEW ADA BATHROOMS SHALL BE REMOVED AND REINSTALLED AS SHOWN.
 10. NEW ADA BATHROOMS SHALL BE REMOVED AND REINSTALLED AS SHOWN.

NEW ADA BATHROOM NOTES:
 1. NEW ADA BATHROOMS SHALL BE REMOVED AND REINSTALLED AS SHOWN.
 2. NEW ADA BATHROOMS SHALL BE REMOVED AND REINSTALLED AS SHOWN.
 3. NEW ADA BATHROOMS SHALL BE REMOVED AND REINSTALLED AS SHOWN.
 4. NEW ADA BATHROOMS SHALL BE REMOVED AND REINSTALLED AS SHOWN.
 5. NEW ADA BATHROOMS SHALL BE REMOVED AND REINSTALLED AS SHOWN.
 6. NEW ADA BATHROOMS SHALL BE REMOVED AND REINSTALLED AS SHOWN.
 7. NEW ADA BATHROOMS SHALL BE REMOVED AND REINSTALLED AS SHOWN.
 8. NEW ADA BATHROOMS SHALL BE REMOVED AND REINSTALLED AS SHOWN.
 9. NEW ADA BATHROOMS SHALL BE REMOVED AND REINSTALLED AS SHOWN.
 10. NEW ADA BATHROOMS SHALL BE REMOVED AND REINSTALLED AS SHOWN.

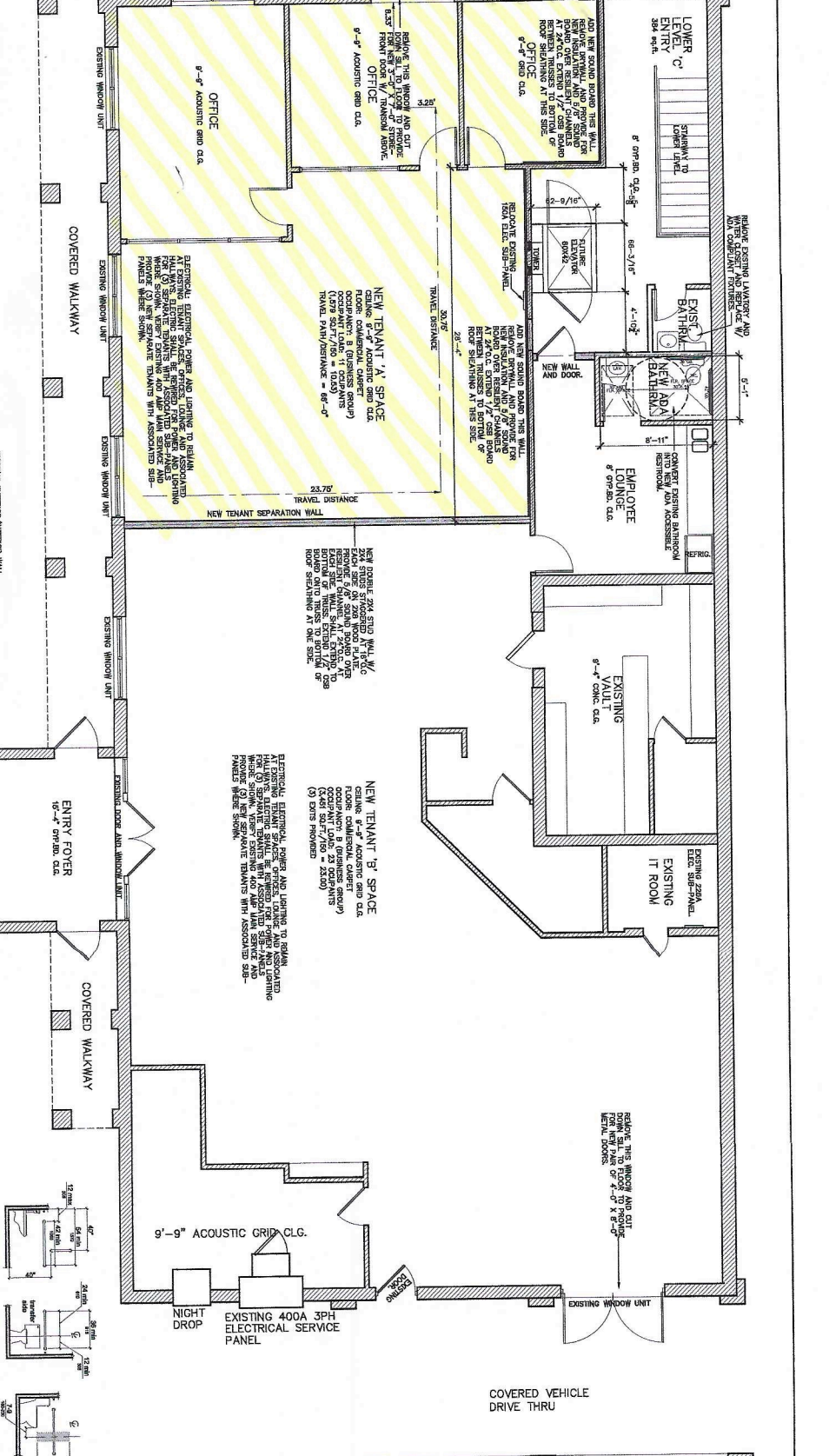

NEW UPPER LEVEL FLOOR PLAN - NORTHVIEW PLAZA
 SCALE: 1/4" = 1'-0"
LEGEND:
 [Symbol] EXISTING RESTROOM/TOILET WALL
 [Symbol] NEW 2x8 OR 2x10 WOOD STUD WALL
 [Symbol] EXISTING RESTROOM/TOILET WALL
 [Symbol] EXISTING NON-BREAKING WALL TO BE REMOVED

NEW ADA BATHROOM NOTES:
 1. NEW ADA BATHROOMS SHALL BE REMOVED AND REINSTALLED AS SHOWN.
 2. NEW ADA BATHROOMS SHALL BE REMOVED AND REINSTALLED AS SHOWN.
 3. NEW ADA BATHROOMS SHALL BE REMOVED AND REINSTALLED AS SHOWN.
 4. NEW ADA BATHROOMS SHALL BE REMOVED AND REINSTALLED AS SHOWN.
 5. NEW ADA BATHROOMS SHALL BE REMOVED AND REINSTALLED AS SHOWN.
 6. NEW ADA BATHROOMS SHALL BE REMOVED AND REINSTALLED AS SHOWN.
 7. NEW ADA BATHROOMS SHALL BE REMOVED AND REINSTALLED AS SHOWN.
 8. NEW ADA BATHROOMS SHALL BE REMOVED AND REINSTALLED AS SHOWN.
 9. NEW ADA BATHROOMS SHALL BE REMOVED AND REINSTALLED AS SHOWN.
 10. NEW ADA BATHROOMS SHALL BE REMOVED AND REINSTALLED AS SHOWN.



DAN SURBER ARCHITECT
 P.O. BOX 3764 SEDONA, ARIZONA
 928-821-2182 86340

PROJECT INFORMATION:
 NORTHVIEW PLAZA TENANT IMPROVEMENT
 TENANT IMPROVEMENT TO EXISTING BUILDING:
 1771 W. STATE ROUTE 89-A SEDONA, AZ. APN. 408-26-0338

DRAWING TITLE:
 NEW UPPER LEVEL FLOOR PLAN

SCALE:
 1/4" = 1'-0"
DATE: 05/15/2024
SHEET: 3 OF 4