

TO LET

SOUTERHEAD INDUSTRIAL CENTRE

BLOCK 1 UNIT 6

SOUTERHEAD ROAD, ALTENS, ABERDEEN, AB12 3LF
144.30 SQ M (1,553 SQ FT)

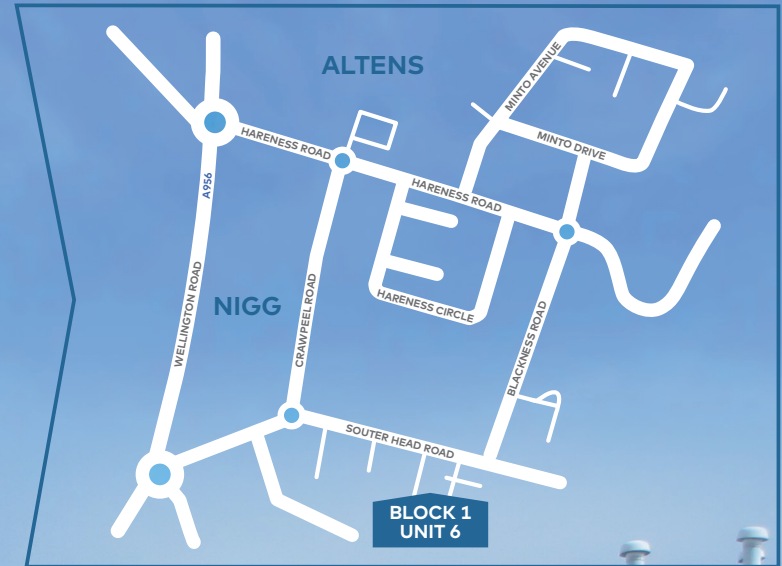

SOUTERHEAD INDUSTRIAL CENTRE

BLOCK 1 UNIT 6

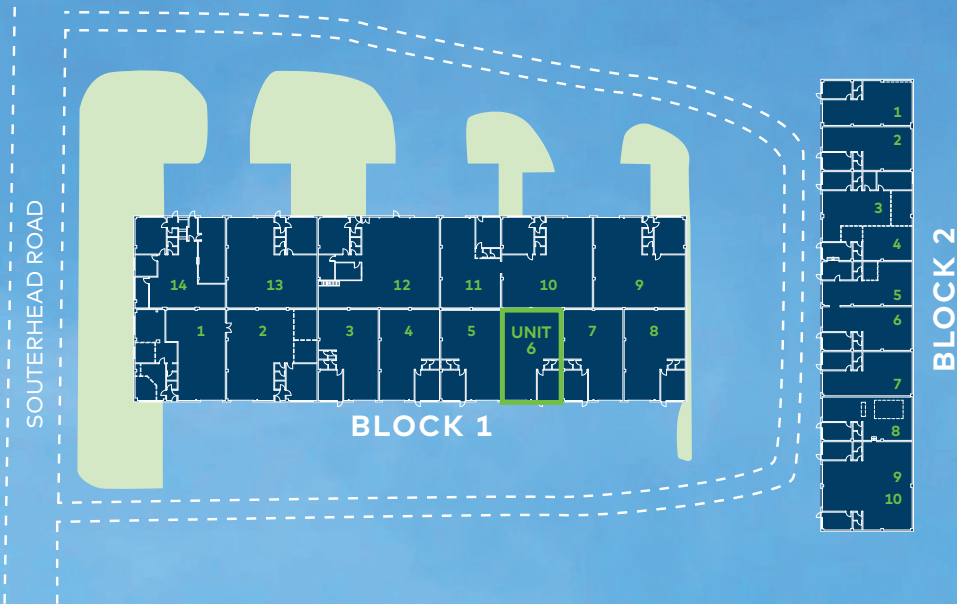
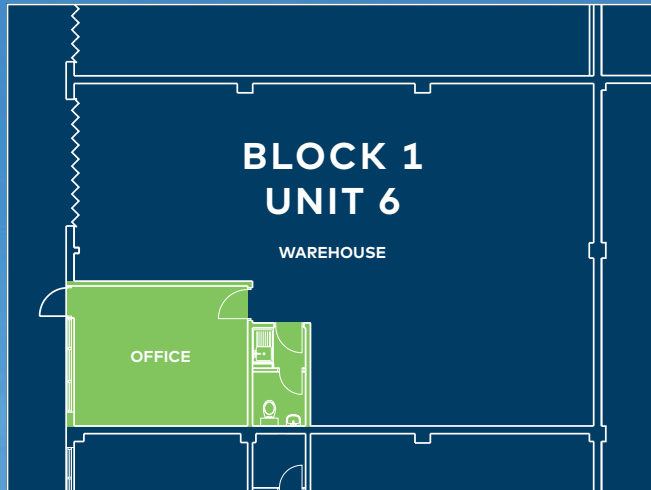

SPECIFICATION

- > 4.5 metre eaves
- > Roller shutter door (3.5m wide x 3m tall)

ACCOMMODATION

Warehouse 124.40 sq.m (1,339 sq.ft.)

Office 19.90 sq.m (214 sq.ft.)

TOTAL 144.30 SQ.M (1,553 SQ.FT.)

LEASE

The unit is available on a new Internal Repairing and Insuring lease.

RENT

£17,000 per annum, exclusive of VAT.



CBRE 1 Albyn Terrace,
Aberdeen, AB10 1YP

T: 01224 219000

Iain Landsman

E: iain.landsman@cbre.com

Amy Tyler

E: amy.tyler@cbre.com

RATEABLE VALUE

£15,500

ESTATE CHARGE

The ingoing tenant will be responsible for a maintenance charge which covers the maintenance of the externals of the unit as well as the common parts of the estate.

ENERGY PERFORMANCE CERTIFICATE (EPC)

The subjects have an EPC rating of G. Full documentation can be provided on request.



Ryden 25 Albyn Place,
Aberdeen, AB10 1YL

T: 01224 588866

Paul Richardson

E: paul.rirchardson@ryden.co.uk

Daniel Stalker

E: daniel.stalker@ryden.co.uk

Misrepresentation Act 1967: Conditions under which particulars are issued: Messrs CBRE and Ryden for themselves and for the vendor of this property, whose agents they are given notice that: 1) These particulars do not constitute, nor constitute any part of an offer or contract. 2) None of the statements contained in these particulars as to this property is to be relied on as a statement or representation of fact. 3) Any intending purchaser must satisfy himself by inspection or otherwise as to the correctness of each of the statements contained in these particulars. 4) The vendor / landlord does not make or give, and neither messrs CBRE, Ryden nor any person in their employment has any authority to make or give any representation or warranty whatever in relation to this property. Finance Act 1989: Unless otherwise stated all prices and rents are quoted exclusive of VAT. Property Misdescription Act 1991: These details are believed to be correct at the time of compilation but may be subject to subsequent amendment. April 2018.