

Unit 3, Ringway Business Park

Richard Street, Nechells, Birmingham B7 4AA



DIRECT LINKS TO
THE UK MOTORWAY
NETWORK



ESTABLISHED
PARK IN
BIRMINGHAM



1.5 MILES TO
BIRMINGHAM
CITY CENTRE



LOCATED OUTSIDE
BIRMINGHAM
CLEAN AIR ZONE

To Let

High Quality Warehouse/Logistics Unit

61,750 sq.ft Total Site are 2.85 acres

Available Now

 camera.advice.tiles

Key Features



Unit 3, Ringway Business Park, 14 Richard St, Nechells, Birmingham B7 4AA



39 tarmac car spaces incl 4 disabled

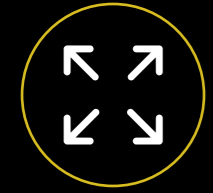

GIA 61,750 sq ft .
98.0 m x 56.0m
plus mezzanine



Concrete yard:
3,035 m² (0.75 acres)



Incl Office W/C block
2,703 sq ft (GIA)



Sprinkler system



8m minimum
eaves height

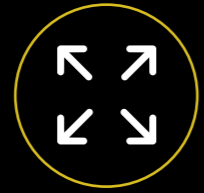

Total site area:
2.85 acres



4 level access doors (4.8 (H) x 4m (W))



Site coverage:
only 50%



LED and sodium
lighting



ENERGY PERFORMANCE
RATING - C64



3 gas-fired hot-air
blowers



OUTSIDE OF THE
BIRMINGHAM CLEAN
AIR ZONE



Concrete power-floated
floor



Junction 6 of the M6 and
Birmingham city centre,
both approximately
1.5 miles away

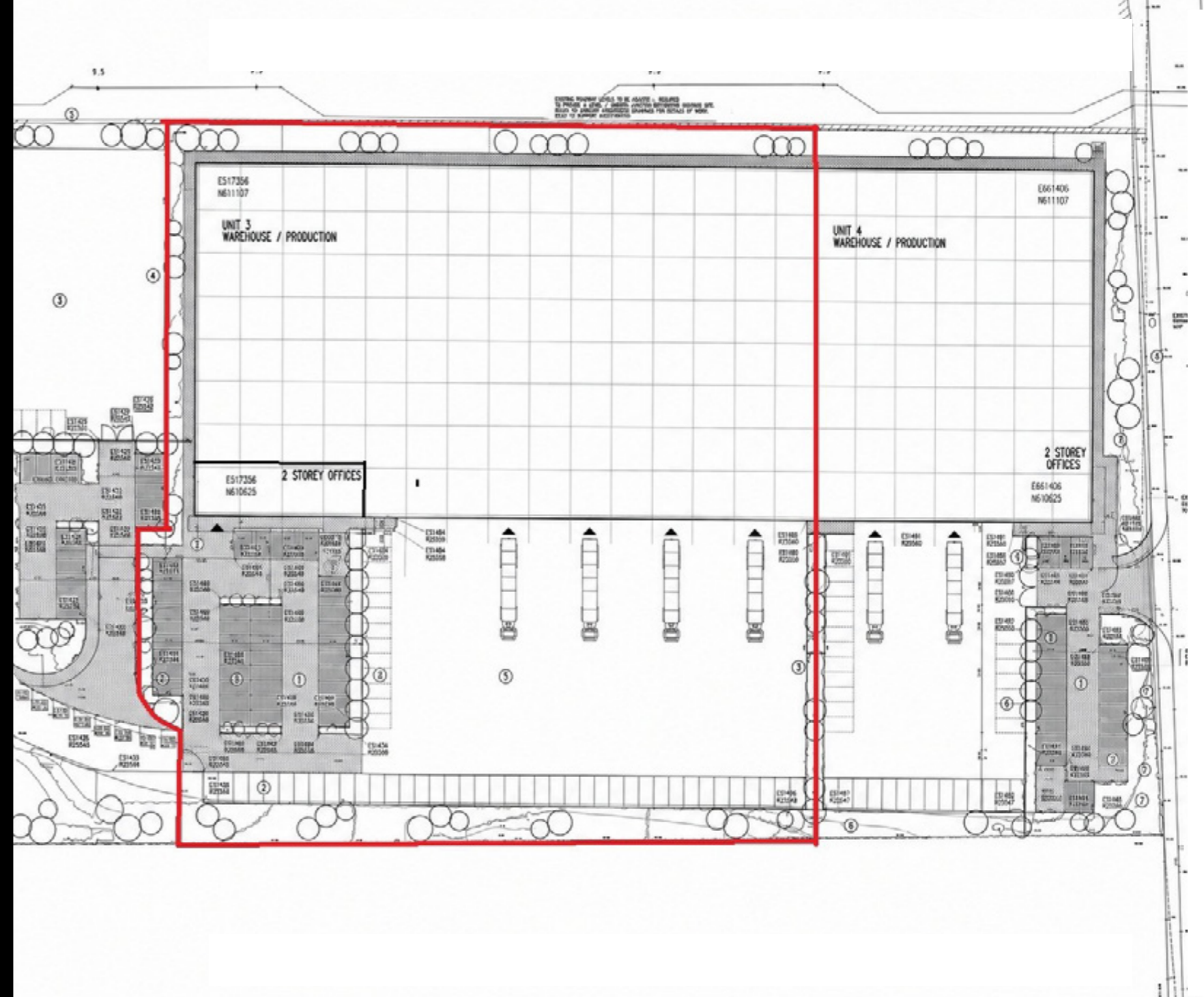



Unit 3, Ringway Business Park, Richard Street, Nechells, Birmingham B7 4AA

Location

Ringway Business Park is situated on Richard Street in the established commercial area of Nechells, approximately 1.5 miles north-east of Birmingham city centre.

The property benefits from excellent road communications, being located immediately off the A4540 Middleway and close to the A38(M), which provides direct access to Junction 6 of the M6 motorway. The location is therefore particularly well suited to occupiers seeking an accessible urban industrial, warehouse or trade-counter facility with convenient links to Birmingham city centre and the wider motorway network.

BIRMINGHAM CLEAN AIR ZONE (CAZ)

The property is located outside the CAZ, benefitting from limited additional transport costs (associated with the CAZ charges of £50 a day per HGV) compared to those companies located within the CAZ

www.brumbreathes.co.uk

KEY LOCATIONS

Location	Distance	Approx. drive time
M6 — Junction 6	1.5 miles	5 minutes
Birmingham city centre	1.5 miles	5–10 minutes
Birmingham Airport	9 miles	20 minutes
Coventry	21 miles	30 minutes
Sheffield	86 miles	1 hour 30 minutes
Manchester	88 miles	1 hour 30 minutes
Bristol	91 miles	1 hour 40 minutes
Leeds	118 miles	2 hours
London	120 miles	2 hours 20 minutes

Distances and journey times are approximate.

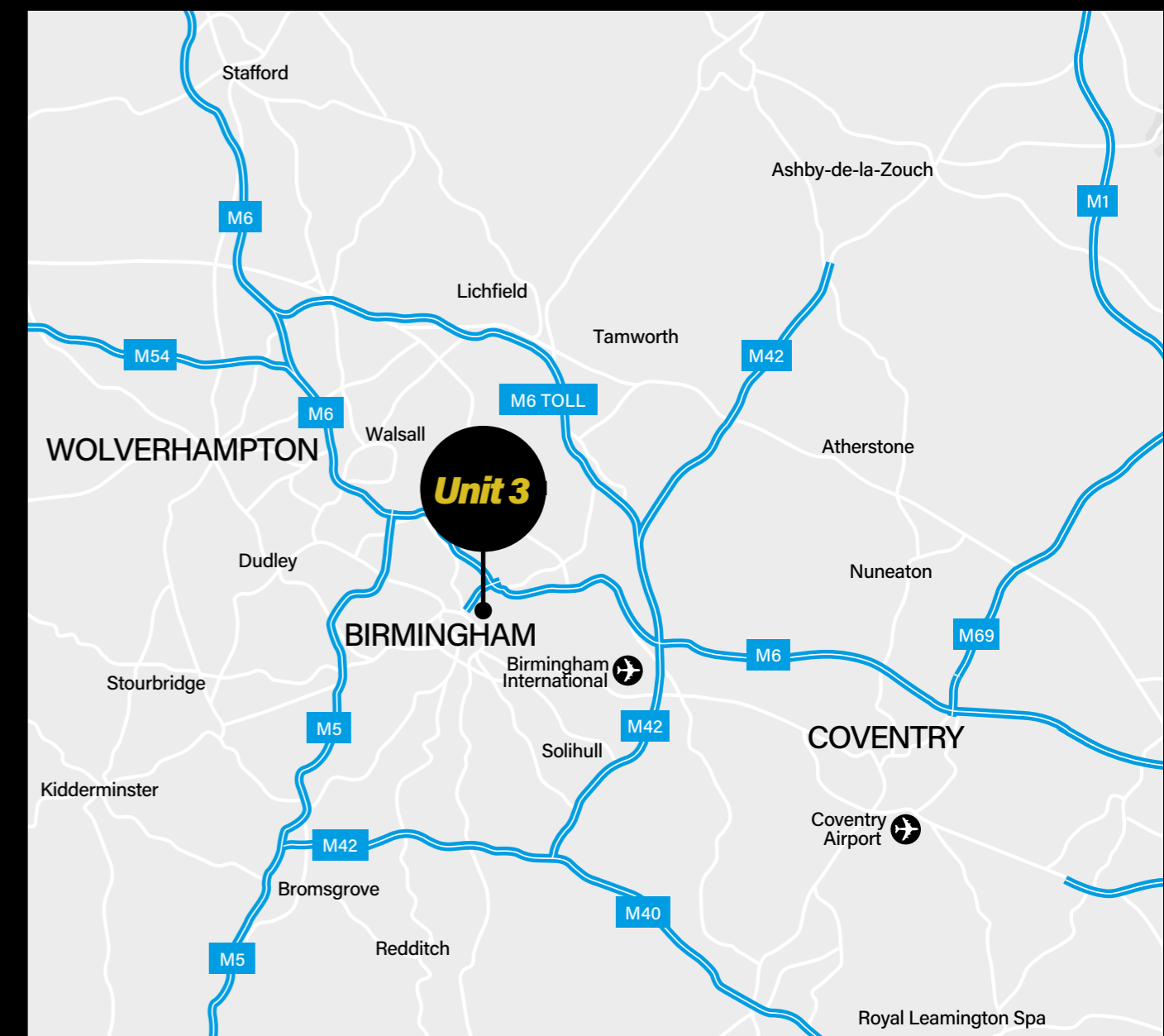
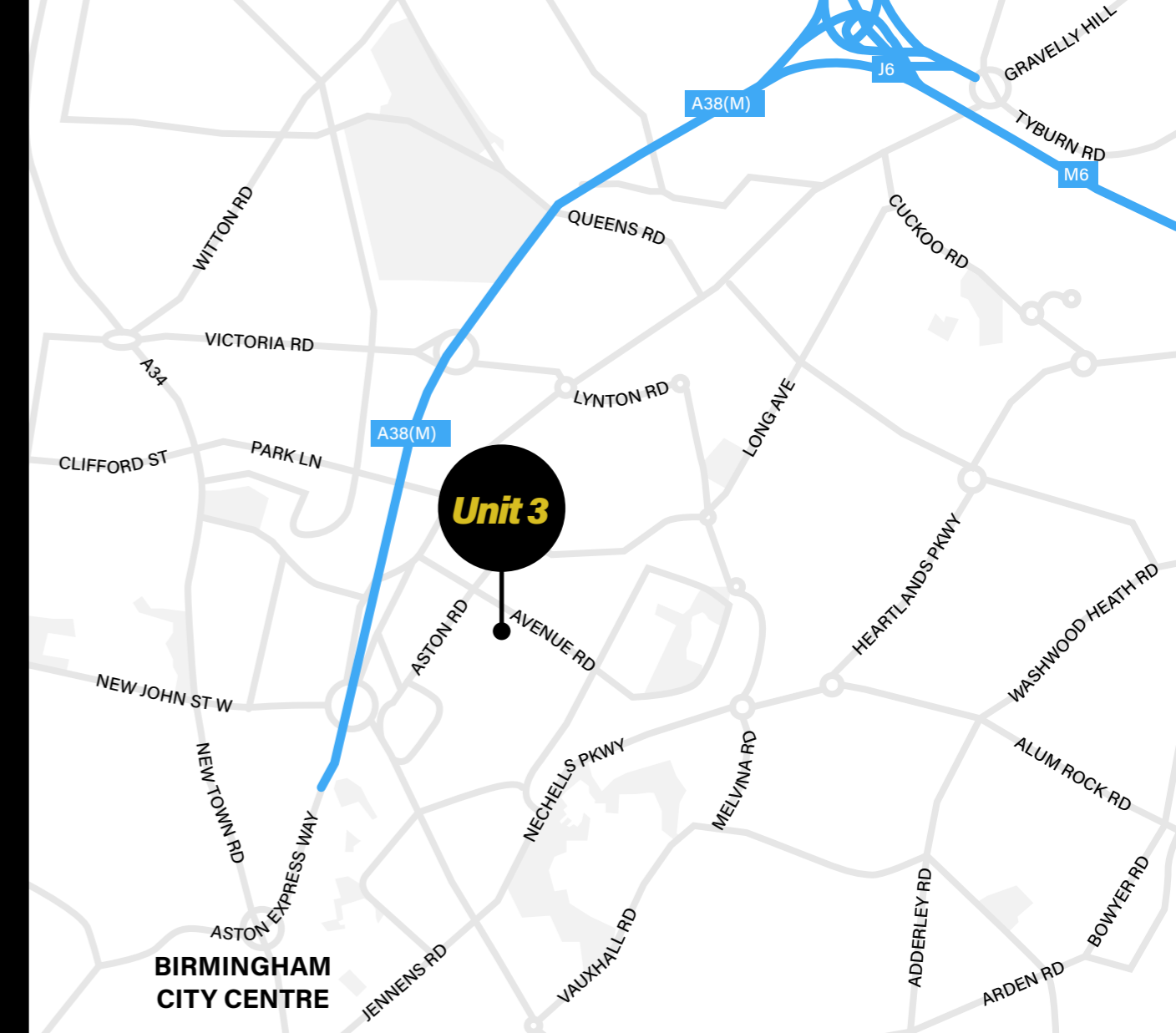

Unit 3, Ringway Business Park, Richard Street, Nechells, Birmingham B7 4AA

Aerial

M6

J6

M6

A38(M)

A38(M)

Unit 3

Unit 3, Ringway Business Park, Richard Street, Nechells, Birmingham B7 4AA

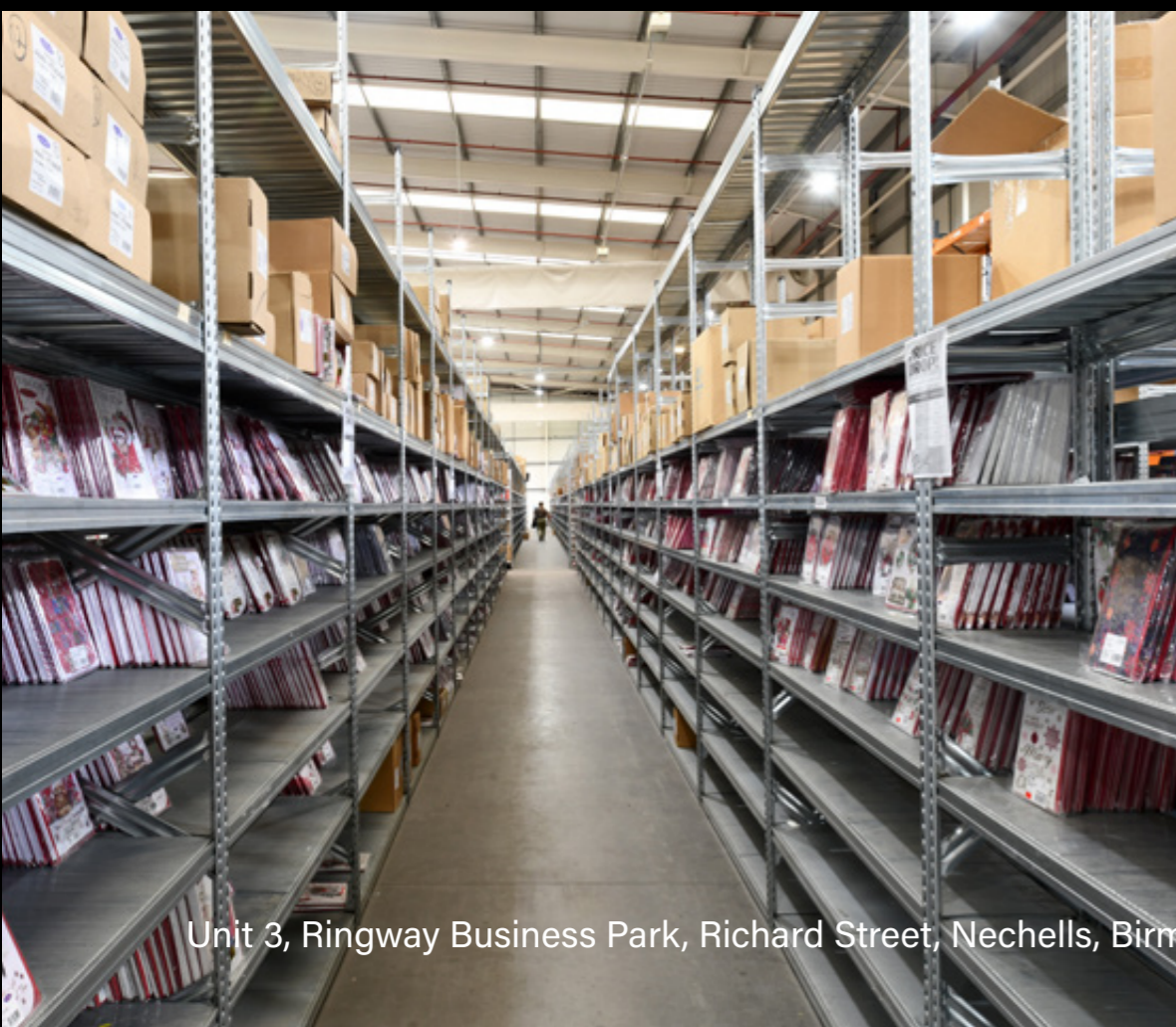

Unit 3, Ringway Business Park, Richard Street, Nechells, Birmingham B7 4AA

Further Information

SERVICES

All mains services available to the property.
Birmingham Available Power supply: 96 kVA

BUSINESS RATES

We understand that the property has a Rateable Value of £405,000 as listed in the 2026 Rating List on the Valuation Office Agency website.

TERMS

The property is available to let on new Full Repairing and Insuring lease terms, for term to be agreed.

RENT

The quoting rent is £555,750 per annum (£9.00 per sq ft).

VAT

VAT will be chargeable at the current rate.

LEGAL COSTS

Each party will be responsible for its own legal costs incurred in the transaction.

Contact

For more information, please contact the agents:

**Fifield
Glyn** 
Chartered Surveyors

0161
839
2444

RICHARD N D SMITH BSc (Hons) MRICS

07966 245 999

Richard.smith@fifieldglyn.com

OLIVIA HENDERSON BSc (Hons)

07399 363 234

olivia.henderson@fifieldglyn.com

IMPORTANT NOTICE: Fifield Glyn gives notice to anyone who may read these particulars as follows: 1. These particulars are prepared for the guidance only of prospective purchasers. They are intended to give a fair overall description of the property but are not intended to constitute part of an offer or contract. 2. Any information contained herein (whether in the text, plans or photographs) is given in good faith but should not be relied upon as being a statement or representation of fact. 3. Nothing in these particulars shall be deemed to be a statement that the property is in good condition or otherwise nor that any services or facilities are in good working order. 4. The photographs appearing in this brochure show only certain parts and aspects of the property at the time when the photographs were taken. Certain aspects may have changed since the photographs were taken and it should not be assumed that the property remains precisely as displayed in the photographs. Furthermore no assumptions should be made in respect of parts of the property which are not shown in the photographs. 5. Any areas, measurements or distances referred to herein are approximate only. 6. Where there is reference in these particulars to the fact that alterations have been carried out or that a particular use is made of any part of the property this is not intended to be a statement that any necessary planning, building regulations or other consents have been obtained and these matters must be verified by any intending purchaser. 7. Descriptions of a property are inevitably subjective and the descriptions contained herein are used in good faith as an opinion and not by way of statement of fact. Published June 2026.

Designed by:
 Blaze
Marketing
blaze-marketing.co.uk