

PRIME LONDON BRIDGE RETAIL FREEHOLD SALE

# 106 Tooley Street

London, SE1 2TH



**Savills London**

33 Margaret  
Street London  
W1G 0JD

[savills.co.uk](http://savills.co.uk)



## Location

The property is located on the southern side of Tooley Street, directly opposite the More London campus. Tooley Street is renowned for its dynamic blend of historic character and contemporary development, offering a bustling environment, with a mix of offices, retail spaces, and residential. The closest station is London Bridge which is only 200 meters away.

Nearby operators include, **Bleecker Burger, Flat Iron, Pizza Pilgrims, Honest Burgers, Santo Remedio** and **Farmer J.**

## Accommodation

The ground floor and basement is occupied by a Bubble tea operator called TT Hanoi. The residential flats have been sold off on long leaseholds.

Ground Floor:	198 sq ft	18.44 sq m
Basement:	193 sq ft	18.01 sq m
<b>Total:</b>	<b>391 sq ft</b>	<b>36.45 sq m</b>

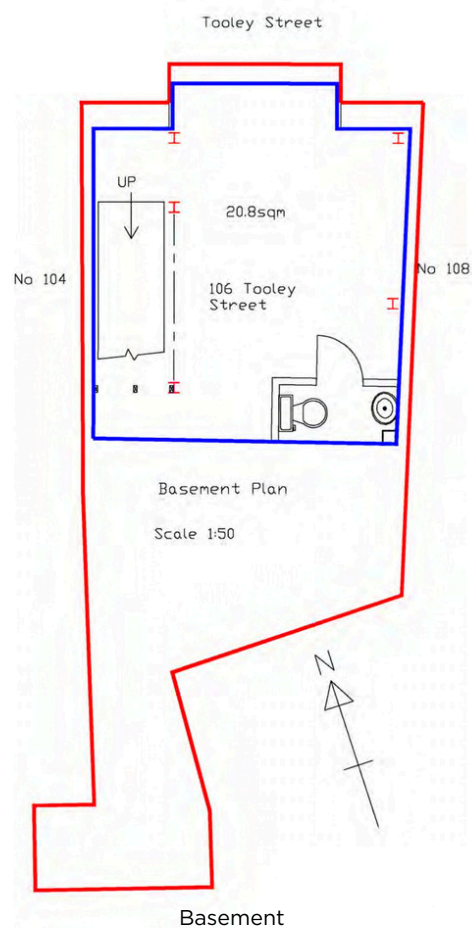
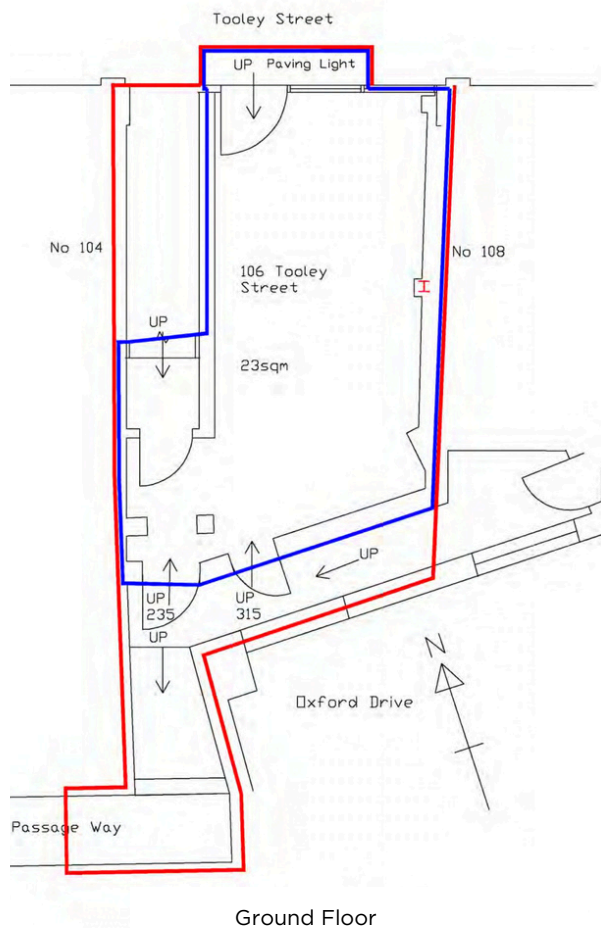

## Viewing & further information

Strictly by prior arrangement only with:

**Bertie Collison**

bertie.collison@savills.com  
+44 (0) 7490 901 213

**Josh Leon**

josh.leon@savills.com



## Price

£525,000

## Tenant

TT Hanoi

## Lease

10 years from 2023 with a mutual break in year 2028.

## User

Class E

## Passing Rent

£35,000

## Reviews

2028

## Legal Costs

Each party to be responsible for their own legal and professional costs incurred in this transaction.

## EPC

A valid EPC for this property can be made available upon request.

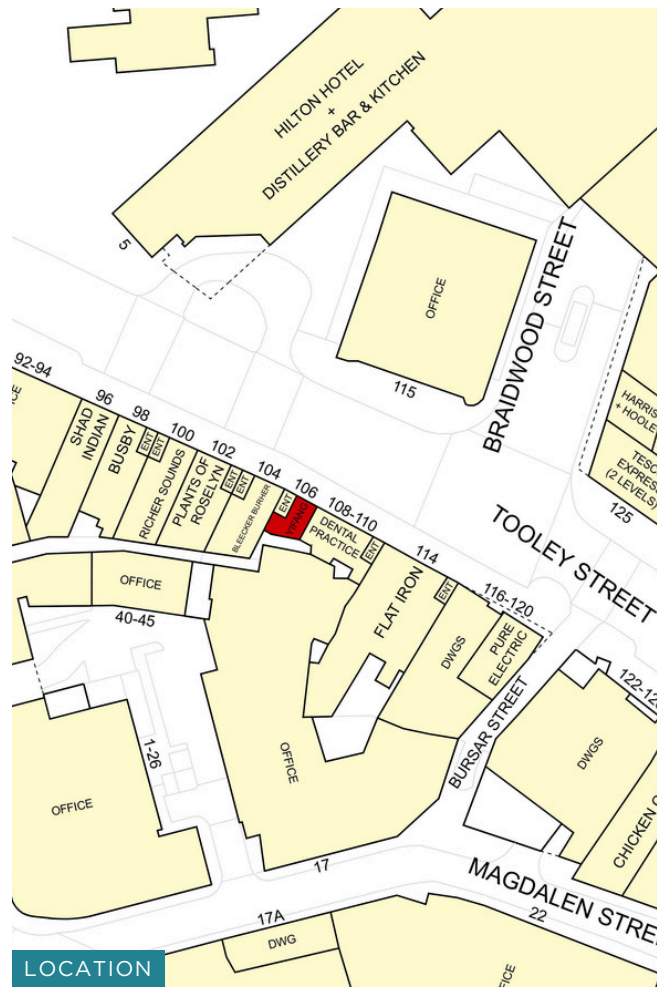

### IMPORTANT NOTICE

Savills, their clients and any joint agents give notice that:

1. They are not authorised to make or give any representations or warranties in relation to the property either here or elsewhere, either on their own behalf or on behalf of their client or otherwise. They assume no responsibility for any statement that may be made in these particulars. These particulars do not form part of any offer or contract and must not be relied upon as statements or representations of fact.  
2. Any areas, measurements or distances are approximate. The text, images and plans are for guidance only and are not necessarily comprehensive. It should not be assumed that the property has all necessary planning, building regulation or other consents and Savills have not tested any services, equipment or facilities. Purchasers must satisfy themselves by inspection or otherwise.

Maps are reproduced from the Ordnance Survey Map with the permission of the Controller of H.M. Stationery Office. © Crown copyright licence number 100022432 Savills (UK) Ltd, and published for the purposes of identification only and although believed to be correct accuracy is not guaranteed. Designed and produced by Savills Marketing: 020 7499 8644 | 2025





We connect the dots  
between landlords,  
brands and powerful  
consumer insights

[Find out more here](#)

**Savills London**

33 Margaret  
Street London  
W1G 0JD

[savills.co.uk](http://savills.co.uk)



savills