

Rolfe East



Northfield Avenue, W13 9RR

£275,000

- High Footfall Location
- Close to Northfields Tube (Piccadilly line)
- Retail Unit
- 999 Year Lease

44 Pitshanger Lane, Ealing, W5 1QY
020 8566 0288

commercial@rolfe-east.com
<https://www.rolfe-east.com/>

Northfield Avenue (commercial unit), London, W13
 Approximate Floor Area = 26.2 sq m / 282 sq ft

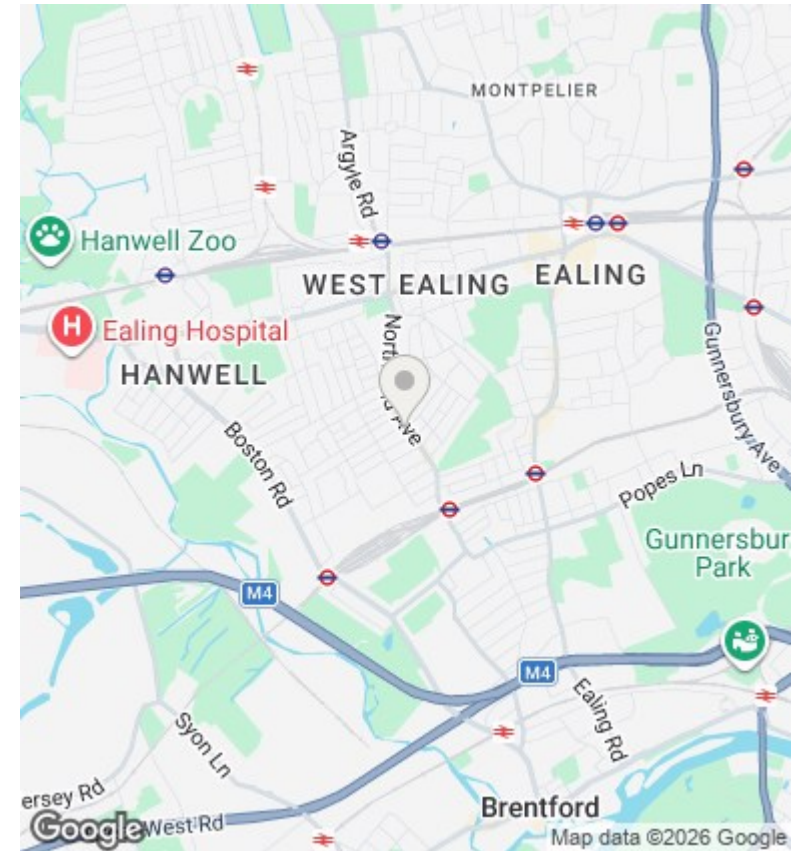
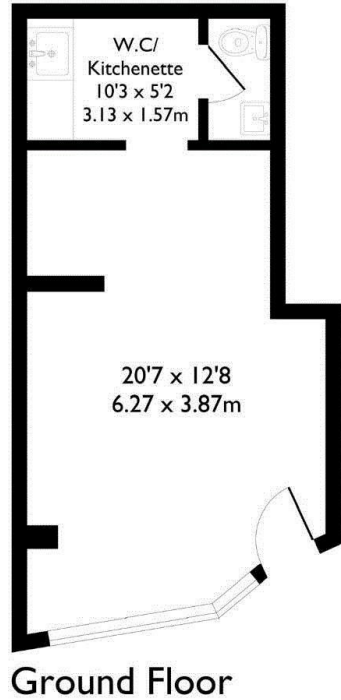

Directions

Viewings

Viewings by arrangement only. Call 020 8566 0288 to make an appointment.

Council Tax Band

EPC Rating:

Energy Efficiency Rating		
	Current	Potential
<i>Very energy efficient - lower running costs</i>		
(92 plus) A		
(81-91) B		
(69-80) C		
(55-68) D		
(39-54) E		
(21-38) F		
(1-20) G		
<i>Not energy efficient - higher running costs</i>		
England & Wales	EU Directive 2002/91/EC	