



Chartered Surveyors &
Commercial Property Consultants

PROMINENT RETAIL UNIT

TO LET / FOR SALE

**GROUND FLOOR, 154 BARTHOLOMEW STREET, NEWBURY
WEST BERKSHIRE, RG14 5HB**

1,025 SQ FT (95.22 SQ M)



Bartholomew House, 38 London Road, Newbury, Berkshire RG14 1JX

www.quintons.co.uk

This information and the descriptions and measurements herein do not form part of any contract and whilst every effort has been made to ensure accuracy, this cannot be guaranteed.

SITUATION

The property occupies a central position within Newbury Town Centre. The property lies at the corner of Bartholomew Street and Mansion House Street both of which lead to Northbrook Street.

Nearby occupiers include Lloyds Bank Plc, British Red Cross, Holland & Barrett and Caffè Nero.

DESCRIPTION

The property comprises a ground floor retail unit with large store, kitchen and WC.

The property is grade 2 listed.

Internally the main retail area includes timber flooring, painted walls, suspended ceiling with a mix of lighting and air conditioning.

The store could form part of the main retail area and includes timber floor, painted walls, spot lights and air conditioning.

Back of house includes a good sized kitchen with WC.

ACCOMMODATION

	Sq. M.	Sq. Ft.
Total	95.22	1,025

RATING ASSESSMENT

Rateable Value £27,500

Rates Payable £11,825 (2026/27)

ENERGY PERFORMANCE CERTIFICATE

This property has an EPC rating of B and a score of 34.

PROPOSAL

The property is available on a new lease the length of which is open to negotiation. The quoting rent is £30,000 per annum exclusive. Alternatively the property is available purchase on a long lease (999 years from approx 2020) at a guide price of £300,000. VAT is applicable.

Bartholomew House, 38 London Road, Newbury, Berkshire RG14 1JX

www.quintons.co.uk

This information and the descriptions and measurements herein do not form part of any contract and whilst every effort has been made to ensure accuracy, this cannot be guaranteed.

LEGAL COSTS

Each party to be responsible for their own legal costs.

VIEWING

Contact Shane Prater / Tom Price. Email: shane@quintons.co.uk / tom@quintons.co.uk
April 2026

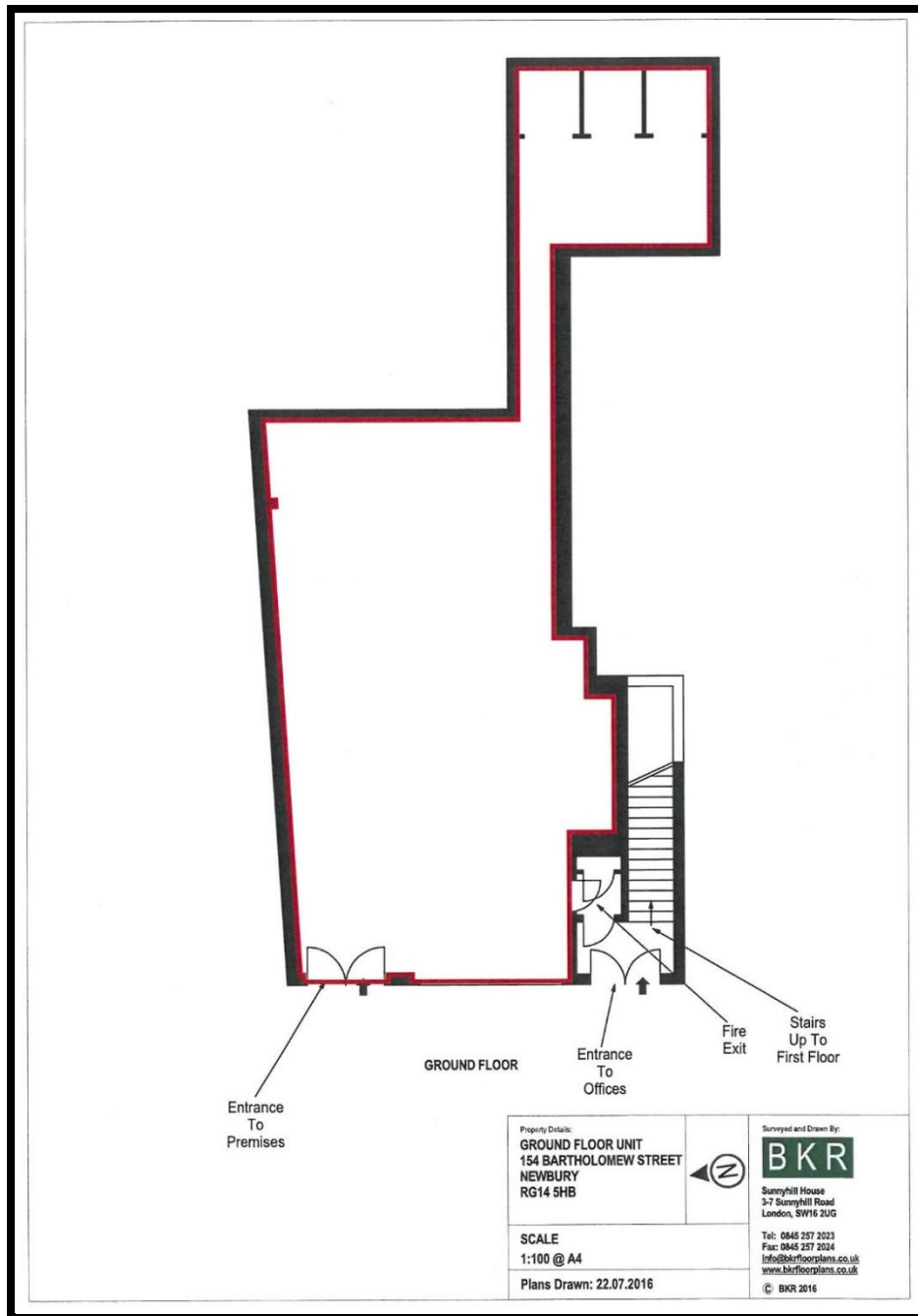

Bartholomew House, 38 London Road, Newbury, Berkshire RG14 1JX

www.quintons.co.uk

This information and the descriptions and measurements herein do not form part of any contract and whilst every effort has been made to ensure accuracy, this cannot be guaranteed.