



TO LET

FIRST FLOOR, 12 HIGH STREET,
SWADLINCOTE, DERBYSHIRE,
DE11 8HY

RETAIL

535 - 1,735 SqFt
(49.7 - 161.18 SqM)

KEY FEATURES

- THREE FIRST FLOOR SELF-CONTAINED UNITS
- CAN BE TAKEN INDIVIDUALLY OR AS A COMBINATION
- WILL BE PRESENTED TO A SHELL SPECIFICATION READY FOR FIT OUT
- ADAPTABLE LAYOUT SUITABLE FOR A VARIETY OF USES

FOLLOW US



01283 517747 | www.rushtonhickman.com

LOCATION

The building is a terraced retail unit of traditional brick and tile construction located on High Street in the Derbyshire market town of Swadlincote. It's situated alongside a number of nearby occupiers, including Greggs, Boots, and Clarks.

Positioned in a highly visible, sought after location on the popular High Street of Swadlincote, these first floor units offer an excellent opportunity for a variety of uses.

Surrounded by a dynamic mix of national brands, independent shops, and thriving local businesses, the property benefits from constant pedestrian and vehicular traffic, making it ideal for both established businesses and new ventures.

DESCRIPTION

The subject property comprises three units on the first floor of High Street. Each unit can be taken independently or can be combined to create larger accommodation.

Units 1 and 2 will be accessed from a new entrance to the front of the property and lead to a first floor shared foyer, with Unit 3 having its own access to the rear of the property.

Each unit will be finished to a shell specification ready for an occupier to fit out internally to their satisfaction.

The units would suit a variety of uses such as hairdressers, beauticians, aesthetics, barber, restaurant, leisure use etc. subject to gaining any necessary consents.

ACCOMMODATION

We have been provided with floor plans which confirm the following floor areas:

Area	Sq Ft	Sq M
Unit 1	604	56.11
Unit 2	535	49.7
Unit 3	596	55.37
Total	1,735	161.18

PLANNING

We understand that the property has the benefit of planning consent for Use Class E (Commercial, Business and Service), but it may be suitable for alternative uses subject to all necessary consents.

Interested parties should confirm all planning information with the local authority (South Derbyshire District Council).

SERVICES

It is understood that all mains services, excluding gas, are connected to the property.

BUSINESS RATES

Upon completion of the units, the rating assessment will be required to be reassessed.

TENURE

Each unit is available to rent either individually or together by way of a new full repairing and insuring lease on terms to be agreed.

PRICE

Each unit is available to rent as follows:

Unit 1 - £8,000 per annum, exclusive
Unit 2 - £7,000 per annum, exclusive
Unit 3 - £7,000 per annum, exclusive

VAT

We understand that VAT is applicable at the prevailing rate. All figures are quoted exclusive of VAT.

ENERGY PERFORMANCE CERTIFICATE

The subject property has an EPC rating of B (48).

LEGAL COSTS

Each party is to be responsible for their own legal costs in connection with this transaction.

12 High Street – Upper Floor

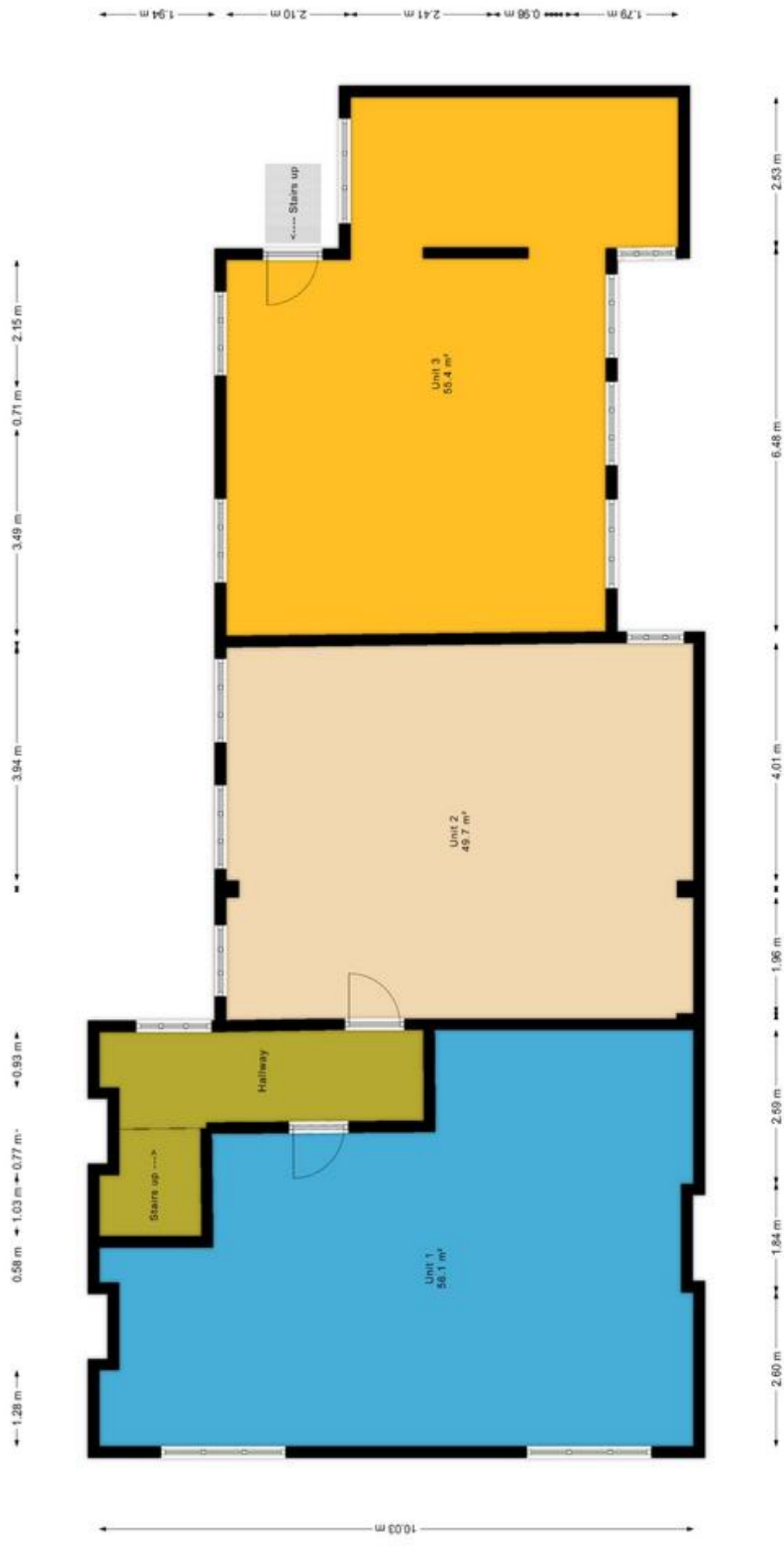

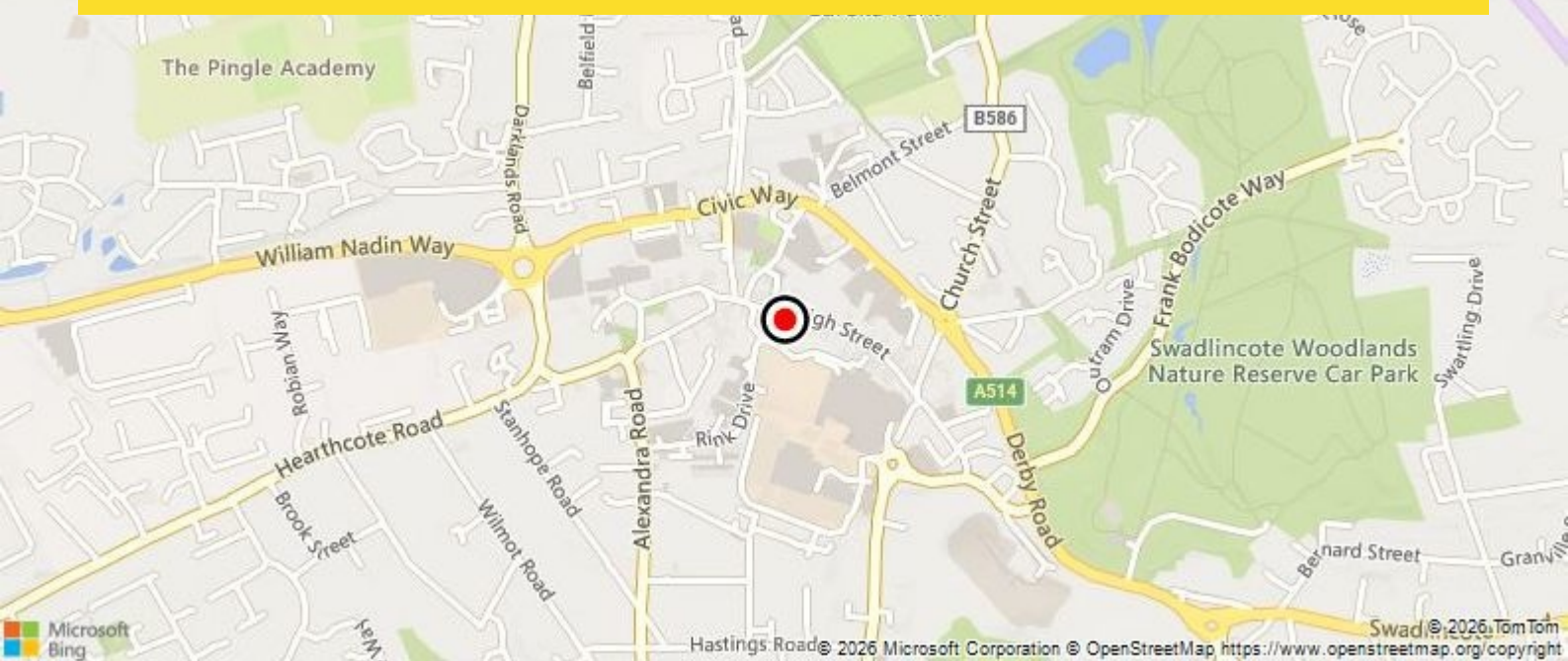

VIEWING

By prior appointment with sole agent Rushton Hickman.



CONTACT

Graham Bancroft
01283 517747
graham.bancroft@rusthonhickman.com



CONTACT

Sam Rowland
01283 387685
sam.rowland@rusthonhickman.com

REFERENCE C3328 - 29012026



FOLLOW  
US
www.rusthonhickman.com
01283 517747

Conditions under which particulars are issued: Rushton Hickman Ltd for themselves and for the vendors or lessors of this property whose agents they are give notice that: (i) the particulars are set out as a general outline only for the guidance of intended purchasers or lessees, and do not constitute, nor constitute part of, an offer or contract; contract; (ii) all descriptions, dimensions, reference to condition and necessary permissions for use and occupation, and other details are given without responsibility and any intending purchasers or tenants should not rely on them as statements or representations of fact but must satisfy themselves by inspection or otherwise as to the correctness of each of them; (iii) no person in the employment of Rushton Hickman Ltd has any authority to make or give any representation or warranty whatever in relation to this property.