

# WHITEHOUSE MEDICAL CENTRE | MILTON KEYNES | MK8 1BU UNIT FOR PHARMACY & UNIT FOR USE AS COFFEE SHOP



**New 30,000 sq ft medical centre opening late summer with two brand new shop units  
737 sq ft & 1,059 sq ft Now available to let**

All enquiries to Punch Retail | 01908 311517 | [www.punch.org.uk](http://www.punch.org.uk) | [info@punch.org.uk](mailto:info@punch.org.uk)



# WHITEHOUSE DEVELOPEMENT|MILTON KEYNES|MK8 1BU

## • Location:

Located on the new Whitehouse development on West Milton Keynes. Constructing a brand new advanced healthcare centre alongside a coffee shop and will serve around 22,500 residents.

- Milton Keynes is ideally positioned and impeccably connected to the rest of the UK.

## • Accommodation:

- PHARMACY UNIT 737 SQ FT
- COFFEE SHOP UNIT 1,059 SQ FT
- Both are brand new units with services connected and high quality fully glazed shop fronts

- **Rent:** Quoting terms on application

## • Legal Costs:

The ingoing tenant to bear the landlord's reasonable legal costs.

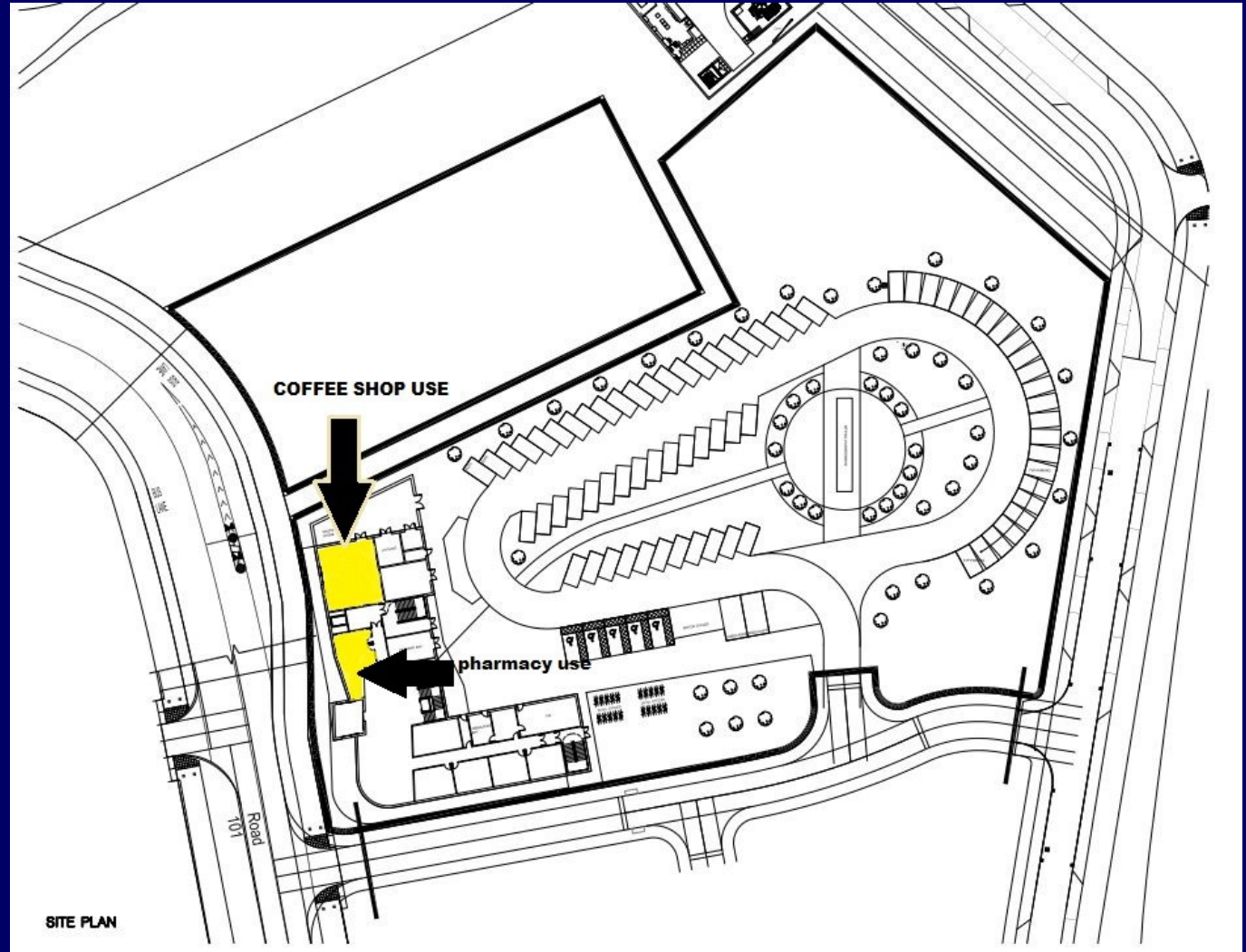

# WHITEHOUSE DEVELOPEMENT|MILTON KEYNES|MK8 1BU

## Viewings:

Further information and viewings strictly by appointment only via

**Patrick Punch 07798 827826**

[pep@punch.org.uk](mailto:pep@punch.org.uk)

## Terms:

Units available on new leases for a term of years to be agreed and further details regarding rent and other terms are available on application to the leasing agents.

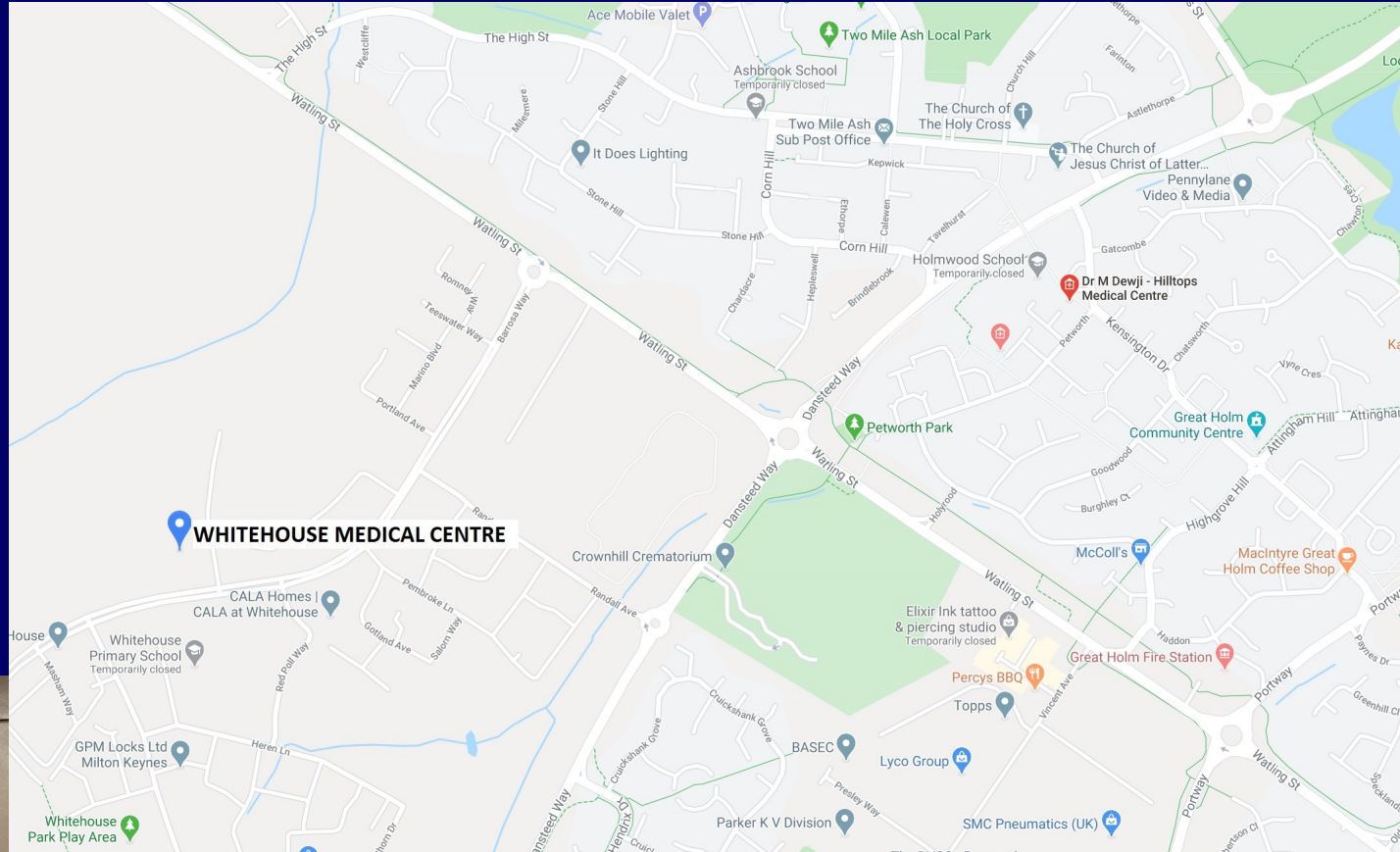

All enquiries to Punch Retail | 01908 311517 | [www.punch.org.uk](http://www.punch.org.uk) | [pep@punch.org.uk](mailto:pep@punch.org.uk)

