

N:\01\2018-01\_SWG\_Grand Parkway Boudreaux Retail\500 CONSTRUCTION DRAWINGS\550 TENANT COORDINATION\2018-01\_LEASE\_22.11.10.dwg revised by Clifford Robinson on 2022-11-29 at 10:12 AM

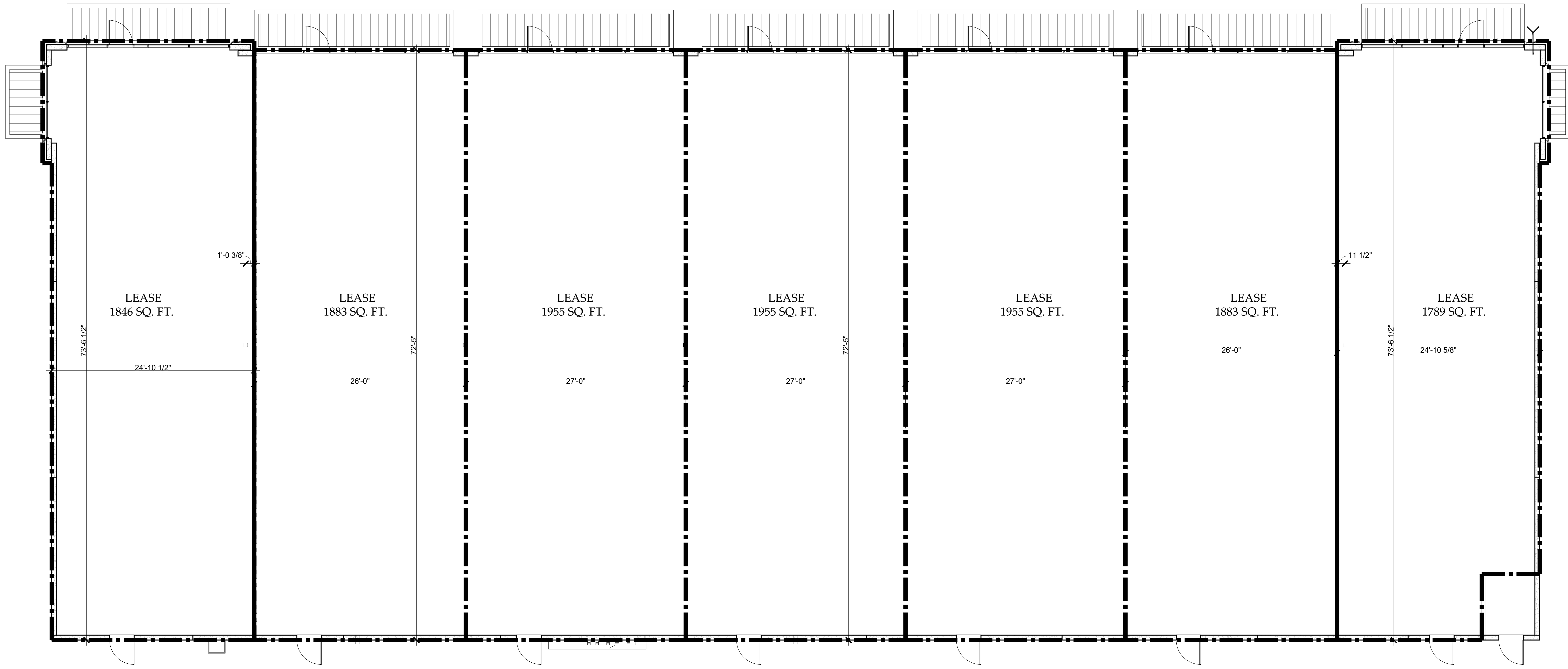

LEASING AREAS

Scale: 1/8" = 1'-0"

**identity**ARCHITECTS

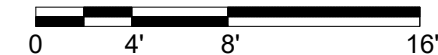

111 Travis Street, Houston, Texas 77002  
www.identityarchitects.com 713.595.2150

COMMERCIAL DEVELOPMENT

February 22, 2022

TOMBALL CROSSROADS  
LEANDER, TX

22018-01\_LEASE\_22.11.10.dwg 10:12 AM

THIS DRAWING IS FOR PRESENTATION PURPOSES ONLY. ANY AND ALL FEATURES, MATTERS AND OTHER INFORMATION DEPICTED HEREON OR CONTAINED HEREIN ARE FOR ILLUSTRATIVE MARKETING PURPOSES ONLY. ARE SUBJECT TO MODIFICATION WITHOUT NOTICE. ARE NOT INTENDED TO BE RELIED UPON BY ANY PARTY AND ARE NOT INTENDED TO CONSTITUTE REPRESENTATIONS AND WARRANTIES AS TO THE SIZE AND NATURE OF IMPROVEMENTS TO BE CONSTRUCTED (OR THAT ANY IMPROVEMENTS WILL BE CONSTRUCTED) OR AS TO THE IDENTITY OR NATURE OF ANY OCCUPANTS THEREOF.