

# UNIT 2A, HOOKSTONE PARK

Harrogate, HG2 7DB



## Key Highlights

- 5,622 sq ft
- Comprehensively refurbished with automated roller shutters, ancillary office space and allocated parking;
- 5.5 miles from Junction 47 of the A1(M)
- Located in an established Industrial/Trade Counter location;
- Prominent location 2 miles east from town centre in the Starbeck area of Harrogate

## Description

Units 2A provide single storey warehouse/trade counter accommodation. The unit has undergone comprehensive refurbishment, suitable for B2 and B8 Trade Counter and industrial/distribution uses. The unit benefits from the following specification:

- Brick construction with a series of pitched roofs over clad with profile metal sheeting;
- Automated roller shutter door to each unit;
- Ancillary office and welfare facilities to each unit;
- Allocated car parking;



## Location

The units are prominently positioned on Hookstone Park in the Starbeck area of Harrogate, approximately 2 miles east of the town centre. Access into the town centre is via Hookstone Chase and the A661, which links Harrogate with Wetherby and Junction 46 of the A1(M) approximately 8 miles to the south east. Junction 47 of the A1(M) is also accessible circa 5.5 miles to the east via Forest Moor Road and the A59.

Surrounding occupiers include Bettys & Taylors of Harrogate Ltd, Platinum HPL, Harvey George, Jollyes, Oldridge Windows, City Plumbing and Crown Decorating Centre.

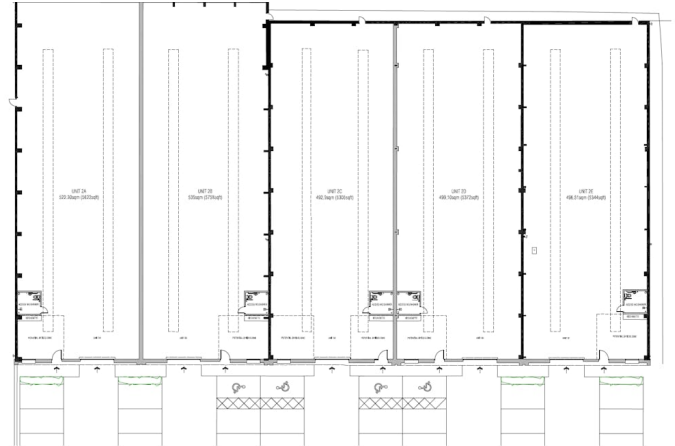

## Accommodation

The accommodation comprises the following areas:

Name	sq ft	sq m	Availability
Ground - Warehouse	5,622	522.30	Available
<b>Total</b>	<b>5,622</b>	<b>522.30</b>	

## Terms

The units are available to rent by way of a Full Repairing and Insuring lease on terms to be agreed. Full details are available on request from the agents.

## EPC

B44

## VAT & Legal Costs

VAT will be charged where applicable. Each party will be responsible for their own legal costs incurred in the transaction.

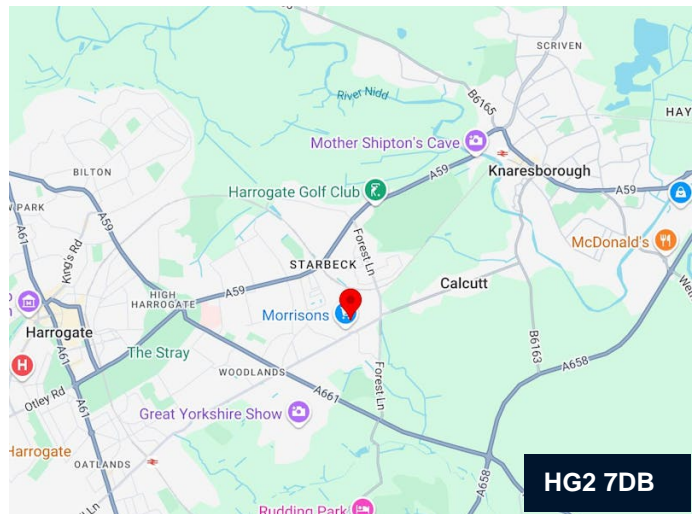

## Robins Associate (Joint Agent)

01423 505 501

## Contact

**Tom Asher**

07738144646

tom.asher@savills.com

**Leona Benfield**

07815 032 132

Leona.benfield@savills.com

## IMPORTANT NOTICE

Savills, their clients and any joint agents give notice that: 1. They are not authorised to make or give any representations or warranties in relation to the property either here or elsewhere, either on their own behalf or on behalf of their client or otherwise. They assume no responsibility for any statement that may be made in these particulars. These particulars do not form part of any offer or contract and must not be relied upon as statements or representations of fact. 2. Any areas, measurements or distances are approximate. The text, photographs and plans are for guidance only and are not necessarily comprehensive. It should not be assumed that the property has all necessary planning, building regulation or other consents and Savills have not tested any services, equipment or facilities. Purchasers must satisfy themselves by inspection or otherwise. Generated by AgentsInsight / Generated on 23/07/2025

**savills**