

1-2 Berners Street,  
Fitzrovia, W1



GERALDEVE



**FULLY FITTED OFFICES TO LET**  
**5th Floor: 783 sq ft (with terrace)**  
**2nd Floor: 5,595 sq ft**

# 1-2 Berners Street, W1

FULLY FITTED OFFICES TO LET  
5,595 – 6,378 SQ FT



## GERALDEVE

2<sup>nd</sup> floor configuration

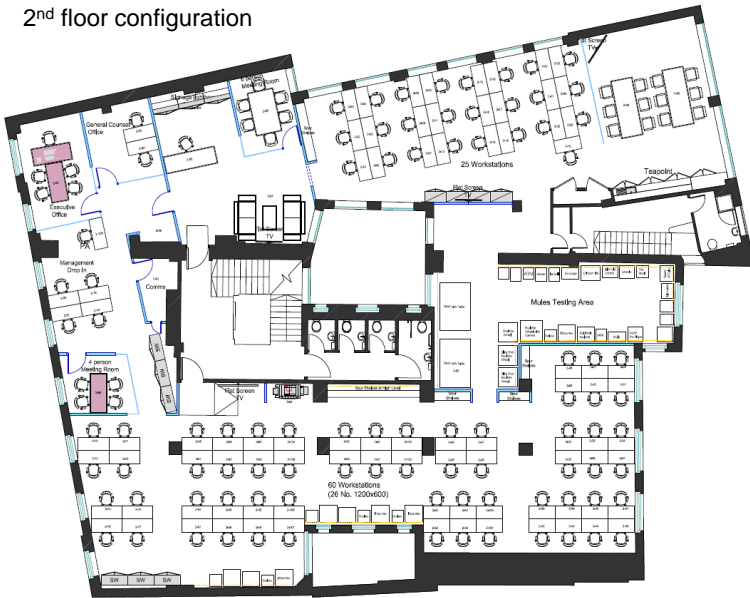

### Location

The Property is located on the east side of Berners Street, in the heart of the West End. It is conveniently located within a short walk of both Oxford Circus Underground station (Victoria, Bakerloo and Central lines) and Tottenham Court Road (Central, Northern & Elizabeth lines). The vibrant surrounding streets of both Fitzrovia and Soho offer superb local amenities with high quality restaurants, coffee shops, bars, international hotels and retail.

### Description

1-2 Berners Street is a modern office building providing fully fitted offices available over the fifth and second floors. The second floor provides a reception area, open plan offices, internal meeting rooms and a kitchenette. The fifth floor currently provides two large meeting rooms, a kitchenette and benefits from a generous roof terrace. The floors are available together or in isolation.

### Specification

- Fully fitted offices
- VRF Air Conditioning
- Raised floors
- Suspended lighting
- Roof terrace (5<sup>th</sup> floor)
- 8-person passenger lift
- Highly presentable ground floor reception
- Commissionaire
- Shower facilities
- Bicycle storage
- EPC Rating 'C – 60'

### Floor Areas

5th Floor: 783 sq ft (+ terrace)  
2nd Floor: 5,595 sq ft  
**Total: 6,378 sq ft**

### Term

Each floor is held on a separate lease for a term through to September 2020 and contracted 'Outside the 1954 Act'. Consideration will be given to a sub-lease or assignment of the leases. Alternatively new lease terms may be available via the landlord.

### Rent

5th Floor: £60.00 per sq ft (passing)  
2nd Floor: £57.50 per sq ft (passing)

### Rates (2018/19)

5th Floor: £17.52 per sq ft  
2nd Floor: £22.37 per sq ft

### Service Charge

£6.00 per sq ft

### Viewing

By appointment through Gerald Eve LLP

Rhodri Phillips  
[RPhillips@geraldve.com](mailto:RPhillips@geraldve.com)  
Tel. 020 3486 3451  
Mob. 07768 615296

Michael Barlow  
[MBarlow@geraldve.com](mailto:MBarlow@geraldve.com)  
Tel. 020 7333 6261  
Mob. 07920 287831

Lucy Cousins  
[LCousins@geraldve.com](mailto:LCousins@geraldve.com)  
Tel. 020 3486 3483  
Mob. 07920 267080

Conditions under which these particulars are issued

All details in these particulars are given in good faith, but Gerald Eve LLP for themselves and the Vendors/Lessors of this property for whom they act give notice that:-

1. These particulars do not and shall not constitute, in whole or in part, an offer or a contract or part thereof, and Gerald Eve LLP have no authority to make or enter into any such offer or contract.
2. All statements contained in these particulars are made without acceptance of any liability in negligence or otherwise by Gerald Eve LLP, for themselves or for the Vendors/Lessors.
3. None of the statements contained in these particulars is to be relied on as a statement or representation of fact or warranty on any matter whatsoever, and intending purchasers must satisfy themselves by whatever means as to the correctness of any statements made within these particulars.
4. The Vendors/Lessors do not make, give or imply, nor do Gerald Eve LLP or any person in their employment have any authority to make, give or imply, whether in these particulars or otherwise, any representation or warranty whatsoever in relation to the property.

This statement does not affect any statutory rights you may have nor does it intend to limit Gerald Eve's liability which cannot be excluded or limited by law. Particulars issued February 2019



GERALDEVE

020 3486 3616  
geraldve.com



GERALDEVE

