

The Langham Estate



Moray House, 23-35
Great Titchfield
Street, London,
W1W 7PA

5TH FLOOR
3,179 SQ FT | 295.34 SQ M
OFFICE TO LET



Moray House, 23-35 Great Titchfield Street - 5th Floor



Location

Moray House is located on the west side of Great Titchfield Street, between Little Portland Street and Mortimer Street, in the heart of vibrant Fitzrovia. Rich in history with a notable artistic and Bohemian heritage, today Fitzrovia is known to be a popular destination attracting fashion, medical, creative and media businesses and offers an ever-growing array of dining, shopping, fitness and leisure facilities.

The area has excellent transport links including 8 underground tube lines spread across 8 stations, as well as the Elizabeth Line.

Connectivity

Oxford Circus	3 mins walk
Goodge Street	6 mins walk
Tottenham Court Road	8 mins walk
Great Portland Street	9 mins walk

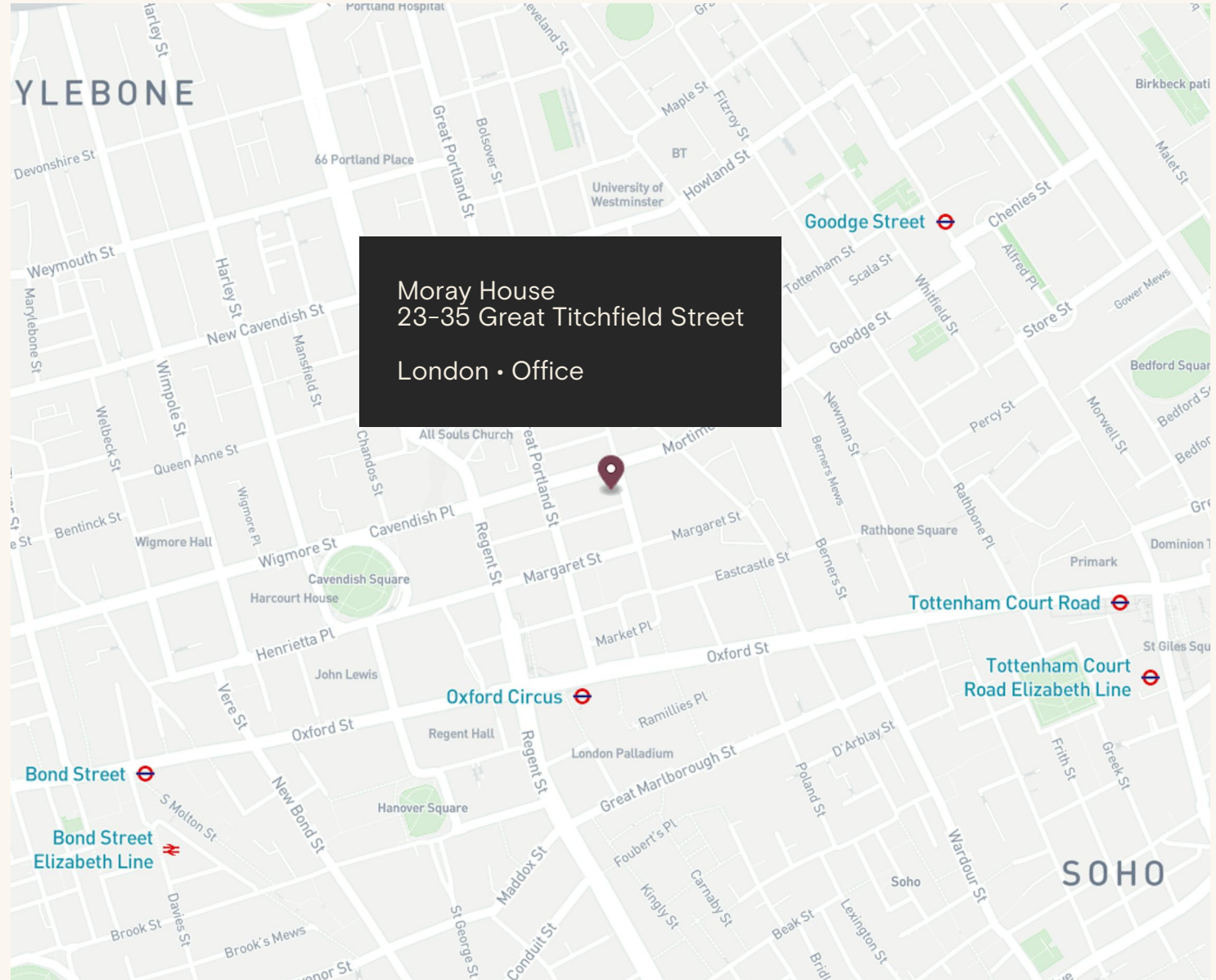

Moray House, 23-35 Great Titchfield Street - 5th Floor



3,179 sq ft office with private terrace and two meeting rooms, available from June





Moray House, 23-35 Great Titchfield Street - 5th Floor



Moray House, 23-35 Great Titchfield Street - 5th Floor



Features

- Good Ceiling Height
- Excellent Transport Links
- Wood Flooring
- Kitchenette
- Perimeter Trunking
- 24 Hour Access
- Terrace
- Excellent natural light

Details

Floor Area

3,179 SQ FT / 295.34 SQ M

Rent

£78 per sq ft

Lease Terms

A new Full Repairing & Insuring Lease is available for a term by arrangement, outside the Landlord & Tenant Act 1954.

Possession

Immediate upon completion of legal formalities

Legal Costs

Each party to be responsible for their own legal costs

VAT

Pricing exclusive of V.A.T

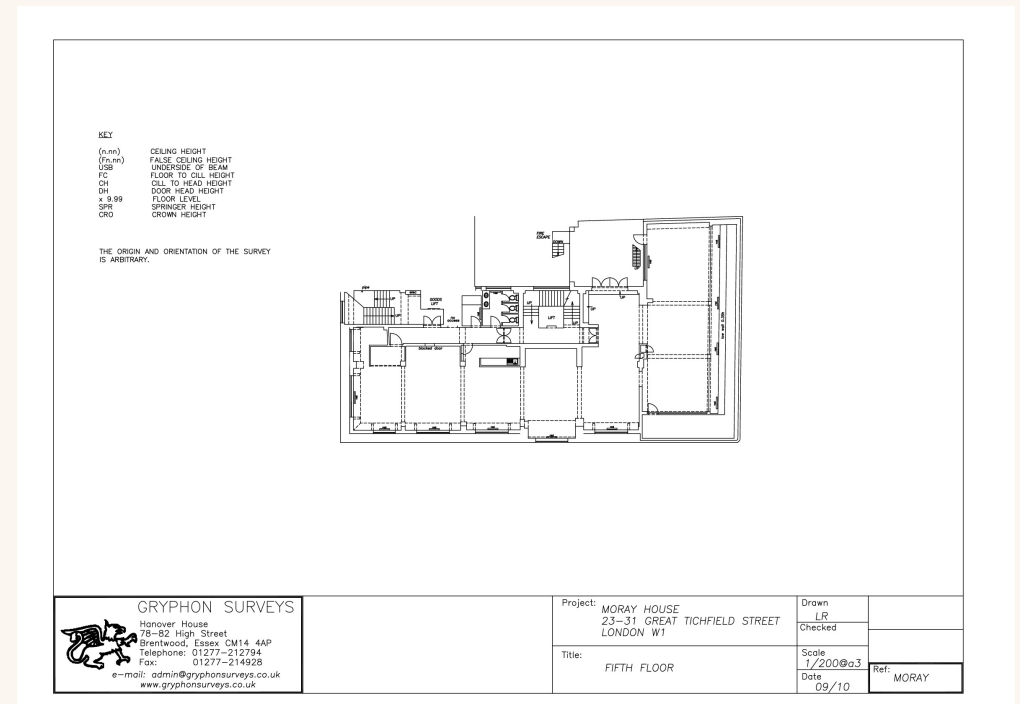

FQ

Discover Fitzrovia Quarter



FITZROVIA QUARTER



Explore our neighbourhood

The Langham Estate

langhamestate.com

For further information call

020 7580 5656



Sabina Bathurst

sabina.bathurst@langhamestate.com

020 7907 4960

07355 603 106

Malcolm Cohen

malcolm.cohen@langhamestate.com

07526 189 462

020 7907 4983